

NOTICE!!

These documents have been scanned!

Do not place un-scanned documents beneath this notice!

Do not remove this notice from this file!

GPO Jacket No. 560-102
Print Order 61540
Rise Business Services, LLC
Job=AZ15 5/10/2019



Box Number= AZ15036



Claim Begin-End: AMC425567-AMC425569

1 Initial Receipt



AZ15036-23

AMC425096-AMC425592

**United States Department of the Interior
Bureau of Land Management
LANDS/RECREATION & PLANNING
ONE N CENTRAL AVE
PHOENIX, AZ 85004 -2203
Phone: 602-417-9200**

Receipt

No: 2951504

Transaction #: 3039382		ENTERED MAR 20 2014 BY: <u>PS</u>
Date of Transaction: 01/16/2014		
CUSTOMER:		
DIANA HANS 19701 E SQUAW VALLEY PKWY BLACK CANYON CITY, AZ 85324-8638 US		

AMENDMENT FILED ON TOP OF ORIGINAL LOCATION NOTICE. *PS*

LINE #	QTY	DESCRIPTION	REMARKS	UNIT PRICE	TOTAL
1	1.00	LOCATABLE MINERALS / MINING CLAIMS- NOT NEW-UNADJUD, ONE AUTH NO. ONLY / MINING CLAIM MONEY RECEIVED CASES: AMC425569/\$10.00	AMEND/1	- n/a -	10.00
TOTAL:					\$10.00

PAYMENT INFORMATION					
1	AMOUNT:	10.00	POSTMARKED:	N/A	
	TYPE:	CASH	RECEIVED:	01/16/2014	
	NAME:	HANS, DIANA 19701 E SQUAW VALLEY PKWY BLACK CANYON CITY AZ 85324-8638 US			

REMARKS

This receipt was generated by the automated BLM Collections and Billing System and is a paper representation of a portion of the official electronic record contained therein.

U.S. DEPARTMENT OF THE INTERIOR
BUREAU OF LAND MANAGEMENT



Mining Claims

Last modified: 03/20/2014 17:00:13

Status: **ACTIVE** Last Assmt Yr: **2014**

Serial Number
AMC425569

[View](#) [Void](#) [Delete](#) [Copy](#)

[Serial Register Page](#)

Case Header Details

Case Type	Claim Name	Commodity	Lead File Nr	Case Acres	Curr Mnt Fee	Military Waiver	Leave Military	Military Expiration
384101	SILVER GATE		AMC425567	20.660	\$140.00			

[Update Header Details](#)

Owner Details

Search Criteria: Search Column: [Search](#)

Proprietor Name(LFI)	Int Rel	Address	Address2	City	State	Zip
CARTER RICHARD W	58	PO BOX 397	19701 E SQUAW VALLEY PKWY	BLACK CANYON CITY	AZ	853240397
HANS DIANA	58	19701 E SQUAW VALLEY PKWY		BLACK CANYON CITY	AZ	853248638

[Update Customer Details](#) # Customers: 2 [Update Multiple Cases](#)

Land Description Details

Meridian: Township: Range: Section: Search Column: [Search](#)

Meridian	Twp	Range	Sec	NE	NW	SW	SE	Geo St	County	Office	SMA
14	0110N	0010E	036	X				AZ	YAVAPAI	HASSAYAMPA FO	PRESCOTT NF
14	0100N	0020E	007		X			AZ	YAVAPAI	HASSAYAMPA FO	BUREAU OF LAND MGMT

[Update Location Details](#) # Locations: [Update Multiple Cases](#)

Action Details

Search Criteria: Search Column: [Search](#)

Date (mm/dd/yyyy)	Code	Action Taken	Action Remarks	Receipt Nr
12/04/2013	403	LOCATION DATE		
12/05/2013	395	RECORDATION NOTICE RECD	1	2924902
12/05/2013	484	LOCATION YEAR / MAINTENANCE FEE	2014;\$140	2924902
03/20/2014	669	LAND STATUS CHECKED		
01/16/2014	635	AMENDED LOCATION FILED	CORRECT LLD	2951504
01/16/2014	392	MONIES RECEIVED	\$10.00;1	2951504
12/05/2013	501	ACCT ADV IN LEAD FILE	AMC425567-AMC425569;	

[Update Action Details](#) # Actions: 7 [Update Multiple Cases](#)

Remarks

Search Criteria: Search Column: [Search](#)

Line #	Remarks
...	No Data Found

[Update Remarks](#) # Remarks: 0 [Update Multiple Cases](#)

Top of Screen

United States Department of the Interior
Bureau of Land Management
 LANDS/RECREATION & PLANNING
 ONE N CENTRAL AVE
 PHOENIX, AZ 85004 -2203
 Phone: 602-417-9200

ENTERED
 DEC 12 2013
 BY: *[Signature]*

Receipt

No: 2924902

Transaction #: 3012108	
Date of Transaction: 12/05/2013	
CUSTOMER:	
RICHARD W CARTER 19701 E SQUAW VALLEY PKWY BLACK CANYON CITY, AZ 85324-8638 US	

LINE #	QTY	DESCRIPTION	REMARKS	UNIT PRICE	TOTAL
1	3.00	LOCATABLE MINERALS / MINING CLAIMS-NEW, UNADJUD, ONE OR MORE AUTH NOS / NEW MINING CLAIM LOCATION FEE \$34 CASES: AMC425567/\$34.00, AMC425568/\$34.00, AMC425569/\$34.00		- n/a -	102.00
2	3.00	LOCATABLE MINERALS / MINING CLAIMS-NEW, UNADJUD, ONE OR MORE AUTH NOS / NEW MINING CLAIM PROCESSING FEE CASES: AMC425567/\$20.00, AMC425568/\$20.00, AMC425569/\$20.00		- n/a -	60.00
3	3.00	LOCATABLE MINERALS / MINING CLAIMS-NEW, UNADJUD, ONE OR MORE AUTH NOS / NEW MINING CLAIM MAINT FEE \$140 CASES: AMC425567/\$140.00, AMC425568/\$140.00, AMC425569/\$140.00		- n/a -	420.00
TOTAL:					\$582.00

PAYMENT INFORMATION			
NOTE: Items will appear on credit card statement as "Bureau of Land Mgmt CO".			
1	AMOUNT:	582.00	POSTMARKED: N/A
	TYPE:	CREDIT CARD	RECEIVED: 12/05/2013
	NAME:	CARTER, RICHARD W 19701 E SQUAW VALLEY PKWY BLACK CANYON CITY AZ 85324-8638 US	
	CARD NO:	XXXXXXXXXXXX9282	AUTH CODE: 902164
	NAME ON CARD:	RICHARD W CARTER	

	EXPIRES: 10/2014
SIGNATURE:	

REMARKS

This receipt was generated by the automated BLM Collections and Billing System and is a paper representation of a portion of the official electronic record contained therein.

NOTICE!!

These documents have been scanned!

Do not place un-scanned documents beneath this notice!

Do not remove this notice from this file!

GPO Jacket No. 560-102
Print Order 61540
Rise Business Services, LLC
Job=AZ15 5/10/2019



Box Number= AZ15036



Claim Begin-End: AMC425567-AMC425569

2 Correspondence



AZ15036-23

AMC425096-AMC425592

**NO
DOCUMENTS
FOUND**

NO DOCUMENTS FOUND
NO DOCUMENTS FOUND

NOTICE!!

These documents have been scanned!

Do not place un-scanned documents beneath this notice!

Do not remove this notice from this file!

GPO Jacket No. 560-102
Print Order 61540
Rise Business Services, LLC
Job=AZ15 5/10/2019



Box Number= AZ15036



Claim Begin-End: AMC425567-AMC425569

3 Transfers



AZ15036-23

AMC425096-AMC425592

WHEN RECORDED MAIL TO: DIANA L. HANS
19701 E. SQUAW Valley Pkwy.
BLACK CANYON CITY, AZ. 85324

QUIT CLAIM DEED

This Quit Claim Deed is made on 7/24/14 between
DIANA L. HANS & RICHARD W. CARTER,
Grantors, of 19701 E. SQUAW Valley Pkwy & 19650 E. SQUAW Valley Pkwy.
City of BLACK CANYON CITY, State of ARIZONA 85324

The undersigned for valuable consideration do hereby quit claim and transfer all
right, title and interest held by the Grantors in the certain property situated in
YAVAPAI County, State of ARIZONA, to
MICHAEL CHAFFEE, of 2750 CISCO DRIVE SOUTH
City of LAKE Havasu City, State of ARIZONA 86403

And described as follows: MINING CLAIMS

- AMC425567 - SILVER CORD - T11N, R01E, SEC 36
- AMC425568 - SILVER DOLLAR - T11N. R01E, SEC 36
- AMC 425569 - SILVER GATE - T10N R02E Sec. 7

Exempt from the Affidavit of Value Requirements by virtue of **ARS 11-1134 A6**

Dated 7/24/14
Grantor Diana L. Hans
Grantor Richard W. Carter

RECEIVED
M AZ STATE OFFICE
2014 AUG - 4 A 10: 09
HIDENIX, ARIZONA

Acknowledgement

State of Arizona County of Maricopa
On July 24, 2014, the Grantors, Diana L. Hans

personally came before me, did state and prove that he/she is the person described in the
above document and that he/she signed the above document in my presence.

Kristen M Taylor
Notary Signature
Notary Public,

In and for the County of Maricopa
My commission expires Jan 25, 2016

Dated 07/24/2014



ENTERED
AUG 07 2014
BY: RM

3092055

INDIVIDUAL ACKNOWLEDGMENT

State/Commonwealth of Michigan
County of Roscommon } ss.

On this the 28th day of July, 2014, before me,
Jessica Spindler, the undersigned Notary Public,
Name of Notary Public
personally appeared Richard W. Carter,
Name(s) of Signer(s)

- personally known to me - OR -
- proved to me on the basis of satisfactory evidence

to be the person(s) whose name(s) is/are subscribed to the within instrument, and acknowledged to me that he/she/they executed the same for the purposes therein stated.

WITNESS my hand and official seal.

Jessica Spindler
Signature of Notary Public

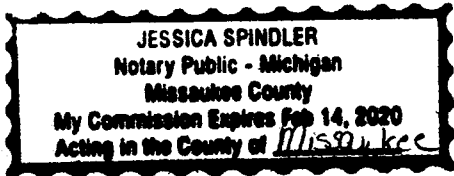

Place Notary Seal/Stamp Above

Any Other Required Information
(Printed Name of Notary, Expiration Date, etc.)

OPTIONAL

This section is required for notarizations performed in Arizona but is optional in other states. Completing this information can deter alteration of the document or fraudulent reattachment of this form to an unintended document.

Description of Attached Document

Title or Type of Document: Quit Claim Deed
Document Date: 7/24/14 Number of Pages: 1
Signer(s) Other Than Named Above: Diana Hans

RECEIVED
PHOENIX
AZ STATE OFFICE
2014 AUG -14 A 10:09

United States Department of the Interior
Bureau of Land Management
 LANDS/RECREATION & PLANNING
 ONE N CENTRAL AVE
 PHOENIX, AZ 85004 -2203
 Phone: 602-417-9200

Receipt

No: 3092055

Transaction #: 3183461	
Date of Transaction: 08/04/2014	
CUSTOMER:	
DIANA HANS 19701 E SQUAW VALLEY PKWY BLACK CANYON CITY, AZ 85324-8638 US	

LINE #	QTY	DESCRIPTION	REMARKS	UNIT PRICE	TOTAL
1	1.00	LOCATABLE MINERALS / MINING CLAIMS- NOT NEW-UNADJUD, ONE AUTH NO. ONLY / MINING CLAIM MONEY RECEIVED CASES: AMC425567/\$30.00	TRF/3	- n/a -	30.00
TOTAL:					\$30.00

PAYMENT INFORMATION			
NOTE: Items will appear on credit card statement as "Bureau of Land Mgmt CO".			
1	AMOUNT:	30.00	POSTMARKED: N/A
	TYPE:	CREDIT CARD	RECEIVED: 08/04/2014
	NAME:	HANS, DIANA 19701 E SQUAW VALLEY PKWY BLACK CANYON CITY AZ 85324-8638 US	
	CARD NO:	XXXXXXXXXXXX7418	AUTH CODE: 071113
	NAME ON CARD:	DIANA L HANS	
	EXPIRES:	04/2017	
	SIGNATURE:		

REMARKS

This receipt was generated by the automated BLM Collections and Billing System and is a paper representation of a portion of the official electronic record contained therein.

NOTICE!!

These documents have been scanned!

Do not place un-scanned documents beneath this notice!

Do not remove this notice from this file!

GPO Jacket No. 560-102
Print Order 61540
Rise Business Services, LLC
Job=AZ15 5/10/2019



Box Number= AZ15036



Claim Begin-End: AMC425567-AMC425569

4 Miscellaneous



AZ15036-23

AMC425096-AMC425592

**NO
DOCUMENTS
FOUND**

NO DOCUMENTS FOUND
NO DOCUMENTS FOUND

NOTICE!!

These documents have been scanned!

Do not place un-scanned documents beneath this notice!

Do not remove this notice from this file!

GPO Jacket No. 560-102
Print Order 61540
Rise Business Services, LLC
Job=AZ15 5/10/2019



Box Number= AZ15036



Claim Begin-End: AMC425567-AMC425569

5 Annual Filings



AZ15036-23

AMC425096-AMC425592

UNITED STATES
DEPARTMENT OF THE INTERIOR
BUREAU OF LAND MANAGEMENT
MAINTENANCE FEE WAIVER CERTIFICATION

436
[Signature]

425567

FORM APPROVED
OMB NO. 1004-0114
Expires: January 31, 2020

SEE INSTRUCTIONS ON PAGE 2

- This small miner waiver is filed for the assessment year beginning on September 1, 2019 and ending on September 1, 2020.
- The undersigned and all related parties owned ten or fewer mining claims, mill, or tunnel sites located and maintained on Federal lands in the United States of America on September 1, 2019.
- The undersigned have performed the assessment work required by law for each mining claim listed prior to filing this waiver and understand that by filing this form, the undersigned must file an affidavit of assessment work with the Bureau of Land Management (BLM) by the December 30th following the filing of this waiver.
- The undersigned understand that if the assessment work obligation has not yet come due under 30 U.S.C. 28 (for those claims in their first assessment year only), a notice of intent to hold reciting this condition must be recorded by the December 30th following the filing of this waiver.
- The undersigned understand that mill and tunnel sites may also be listed on this waiver and be waived from payment of the maintenance fee, and that a notice of intent to hold for these sites is required to be filed with the BLM by the December 30th following the filing of this waiver.
- The undersigned understand and acknowledge that pursuant to 43 U.S.C. 1212 and 18 U.S.C. 1001, the filing or recording of a false, fictitious, or fraudulent document with the BLM may result in a fine of up to \$250,000, a prison term not to exceed five years, or both.
- The mining claims, mill or tunnel sites for which this waiver from payment of the maintenance fees is requested are:

CLAIM OR SITE NAME	BLM RECORDATION SERIAL NUMBER
1. SILVER DOLLAR ✓	AMC 425568
2. SILVER GATE	AMC 425569
3.	
4.	
5.	
6.	
7.	
8.	
9.	
10.	

RECEIVED
BLM AZ STATE OFFICE
2019 AUG 28 P 3:10
PHOENIX, ARIZONA

The owner(s) (claimants) of the above mining claims and sites are:

MICHAEL M. CHAFFEE
(Owner's Name - Please Print)

2750 CISCO DR. SOUTH
(Owner's Mailing Address)

(Owner's Signature)

LAKE HAVASU CITY AZ 86403
(City) (State) (Zip Code)

(Owner's Name - Please Print)

(Owner's Mailing Address)

(Owner's Signature)

(City) (State) (Zip Code)

(Owner's Name - Please Print)

(Owner's Mailing Address)

(Owner's Signature)

(City) (State) (Zip Code)

(Owner's Name - Please Print)

(Owner's Mailing Address)

(Owner's Signature)

(City) (State) (Zip Code)

(Continued on page 2) SEP 16 2019

ENTERED
BY: *[Signature]*

#4549071

NW *[Signature]*

DEPARTMENT OF THE INTERIOR
BUREAU OF LAND MANAGEMENT
MINING CLAIMS

Run Date/Time: 8/20/2018

MC Maintenance Fees Paid Through the BLM Pay Portal
(by Date Paid)

Page 190 Of 316

CBS Receipt: 4235439

Printed For Lead File # AMC425567

Agency Tracking ID: 1534257484

Assessment Year: 2019

Number of BLM Serial Nr: 5

Paid On: 8/14/2018

Total Amount Paid: \$775.00

Claim Name	BLM Serial No	Lead File No	Amount Paid
SILVER CORD	AMC425567	AMC425567	\$155.00
SILVER DOLLAR	AMC425568	AMC425567	\$155.00
SILVER GATE	AMC425569	AMC425567	\$155.00
GOLDEN SUN LODE	AMC433889	AMC433889	\$155.00
GOLDEN SUN #2 LODE	AMC433890	AMC433889	\$155.00

**United States Department of the Interior
Bureau of Land Management
BUSINESS & SUPPORT SVCS DIV
ONE N CENTRAL AVE SUITE 800
PHOENIX, AZ 85004 -4427
Phone: 602-417-9200**

Receipt

No: 4235439

Transaction #: 4350800	
Date of Transaction: 08/14/2018	
CUSTOMER:	
MICHAEL CHAFFEE 2750 CISCO DRIVE SOUTH LAKE HAVASU CITY, AZ 86403 US	

LINE #	QTY	DESCRIPTION	REMARKS	UNIT PRICE	TOTAL
1	1.00	LOCATABLE MINERALS / MINING CLAIMS- NOT NEW-UNADJUD, ONE AUTH NO. ONLY / MINING CLAIM MONEY RECEIVED CASES: AMC425567/\$775.00		- n/a -	775.00
TOTAL:					\$775.00

PAYMENT INFORMATION				
NOTE: Items will appear on credit card statement as "BLM O Mining Claim".				
1	AMOUNT:	775.00	POSTMARKED:	N/A
	TYPE:	CREDIT CARD	RECEIVED:	08/14/2018
	NAME:	MICHAEL CHAFFEE 2750 CISCO DRIVE SOUTH LAKE HAVASU CITY AZ 86403 US		
	CARD NO:	XXXXXXXXXXXX7558	AUTH CODE:	03277G
	NAME ON CARD:	MICHAEL CHAFFEE		
	SIGNATURE:			

REMARKS

This receipt was generated by the automated BLM Collections and Billing System and is a paper representation of a portion of the official electronic record contained therein.

433889
425567

MAINTENANCE FEE PAYMENT

Claimant Name: Michael M. Chaffee
Address: 2750 Cisco Drive South
City: Lake Havasu City State: AZ Zip: 86403
Telephone: 928-680-5513
E-mail address: worm@citlink.net

Signature: *M. M. Chaffee*

(This is not a change of address)

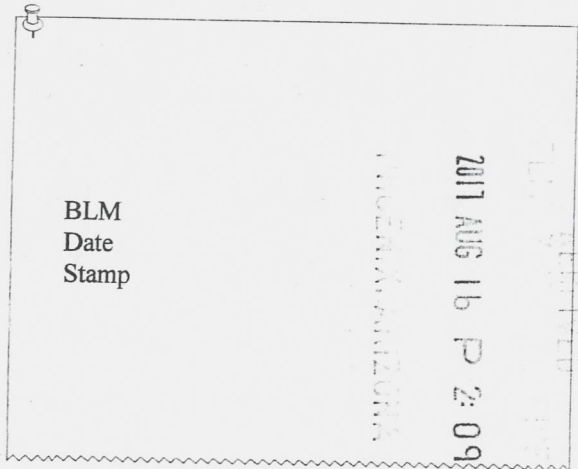

Line No.	AMC Number	Claim/site Name	County Recorder Data	TWP	RNG	SEC
1	433890	Golden Sun #2	2015-0044221	11N	01	9
3	433889	Golden Sun	2015-0044222	11N	01	9
4	425567	Silver Cord	2014-0035137	11N	01E	36
5	425568	Silver Dollar	2014-0035137	11N	01E	36
6	425569	Silver Gate	2014-0035137	10N	02E	7
7						
8						
9						

Bureau of Land Management
Arizona State Office
www.az.gov

No. of Claims: 5 x \$155 = \$775.00

Check No.: 8191

Receipt No: 3942740

For BLM Use Only

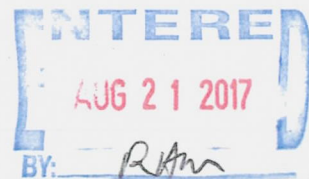

Michael M. Chaffee.

2750 Cisco Drive South, LAKE HAVASU CITY, ARIZONA 86403
TEL: (928) 680-5513 . FAX: (928) 680-7066
E-MAIL: warm@citlink.net or www.westernsierramining.com

RECEIVED
2017 AUG 16 P 2:09
PHOENIX, ARIZONA

14 August, 2017

TRANSMITTAL LETTER

TO: Bureau of Land Management
One N. Central Ave. Suite 800
Phoenix, Arizona 85004-4427

Please find enclosed our check number 8191 in the amount of \$775.00 for our Maintenance Fee Payment on the attached listed 5 mining claims for the period 2017-2018.

We have enclosed a return stamped envelope so you could provide us with a certified copy.

As always, thank you for your assistance in this matter,

Sincerely,



Michael M. Chaffee



8604

4028

FedEx Express Package US Airbill

Tracking Number 8070 6229 4861

FedEx TRK# 8070 6229 4861

98 ZSYA

WED - 16 AUG 10:30A MORNING 2DAY

85004 AZ-US PHX



Form 02

1 From
Date 2-11-17
Sender's Name M. CHAFFEE Phone 928 690-3513
Company LSA CONSTRUCTION
Address 3750 DUNN DR S
City LAKE HAVASU CITY State AZ ZIP 86403-9110

2 Your Internal Billing Reference

3 To
Recipient's Name
Company BUREAU OF LAND MANAGEMENT
Address ONE N. CENTRAL AVE SUITE 300
City PHOENIX State AZ ZIP 85004



8070 6229 4861

4 Express Pack FTD 452819 14AUG17 1HUA 546C1/577E/0C8A

Next Business Day
FedEx First Overnight
FedEx Priority Overnight
FedEx Standard Overnight

2 or 3 Business Days
FedEx 2Day A.M.
FedEx 2Day
FedEx Express Saver

5 Packaging *Declared value limit \$500.
FedEx Envelope* FedEx Pak* FedEx Box FedEx Tube Other

6 Special Handling and Delivery Signature Options
SATURDAY Delivery
No Signature Required
Direct Signature
Indirect Signature
Does this shipment contain dangerous goods?
One box must be checked
No Yes
Dry Ice
Cargo Aircraft Only

7 Payment Bill to:
Sender Recipient Third Party Credit Card
Total Packages Total Weight
Obtain recip. Acct. No.



Insert shipping document here.

fedex.com 1-800-SH-FEDEX 1-800-453-3339

United States Department of the Interior
Bureau of Land Management
 DIV OF LANDS, MINRLS & ENERGY
 ONE N CENTRAL AVE
 PHOENIX, AZ 85004 -4427
 Phone: 602-417-9200

Receipt

No: 3942740

Transaction #: 4052414	
Date of Transaction: 08/17/2017	
CUSTOMER:	
MICHAEL M CHAFFEE 2750 CISCO DR S LAKE HAVASU CITY, AZ 86403-5110 US	

LINE #	QTY	DESCRIPTION	REMARKS	UNIT PRICE	TOTAL
1	1.00	LOCATABLE MINERALS / MINING CLAIMS- NOT NEW-UNADJUD, ONE AUTH NO. ONLY / MINING CLAIM MONEY RECEIVED CASES: AMC433890/\$775.00	MAINT 2018/6	- n/a -	775.00
TOTAL:					\$775.00

PAYMENT INFORMATION					
1	AMOUNT:	775.00	POSTMARKED:	08/14/2017	
	TYPE:	CHECK	RECEIVED:	08/16/2017	
	CHECK NO:	8191			
	NAME:	LSA CONSTRUCTION 2750 CISCO DR S LAKE HAVASU CITY AZ 86403-5110 US			

REMARKS

This receipt was generated by the automated BLM Collections and Billing System and is a paper representation of a portion of the official electronic record contained therein.

Michael M. Chaffee.

AMC 425567

RECEIVED
BLM AZ STATE OFFICE

2016 AUG 25 P 1:23

2750 Cisco Drive South, LAKE HAVASU CITY, ARIZONA 86403

TEL: (928) 680-5513 . FAX: (928) 680-7066

E-MAIL: wsrcm@citlink.net or www.westernsierramining.com

PHOENIX, ARIZONA

Amc 433889

22 August, 2016

TRANSMITTAL LETTER

TO: Bureau of Land Management
One N. Central Ave. Suite 800
Phoenix, Arizona 85004-4427

Please find enclosed our check number 1025 in the amount of \$620.00 for our Maintenance Fee Payment on the attached listed 4 mining claims for the period 2016-2017.

We have enclosed a return stamped envelope so you could provide us with a certified copy.

As always, thank you for your assistance in this matter,

Sincerely,

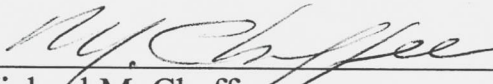

Michael M. Chaffee

AC 782 (2017)
ENTERED AUG 29 2016
PB

ENTERED
AUG 29 2016
BY: R Am

MAINTENANCE FEE PAYMENT

Claimant Name: Michael M. Chaffee
 Address: 2750 Cisco Drive South
 City: Lake Havasu City State: AZ Zip: 86403
 Telephone: 928-680-5513
 E-mail address: worm@citlink.net

Signature: _____

(This is not a change of address)

Ac 782 (2017)
ENTERED AUG 29 2016
line 1-3 PB

BLM
Date
Stamp

**RECEIVED
BLM AZ STATE OFFICE
PHOENIX, ARIZONA
2016 AUG 25 P 1:23**

Line No.	AMC Number	Claim/site Name	County Recorder Data	TWP	RNG	SEC
* 1	425567	Silver Cord	2014-0035137	11N	01E	36
* 2	425568	Silver Dollar	2014-0035137	11N	01E	36
* 3	425569	Silver Gate	2014-0035137	10N	02E	7
	432432	Golden Sun	2015-0016463	11N	01W	9
	433889					
6		<i>Correction Request Rec'd via EMAIL on 8/30/16. PB see ATTACHED PB</i>				
7						
8						
9						

432432 IS CLOSED

Ac 782 (2017)
ENTERED SEP 01 2016
PB

Bureau of Land Management
 Arizona State Office
www.az.gov

No. of Claims: 4 x \$155 = \$620.00

Check No.: 1025

Receipt No.: 3642480

For BLM Use Only



10001
002B

FedEx Package
Express US Airbill

FedEx Tracking Number 8070 6229 4839

FedEx
TRK# 0215 8070 6229 4839

THU - 25 AUG AA
EXPRESS SAVER

98 ZSYA

85004
AZ-US
PHX



FTD 452019 22AUG16 LHUA 539C1/1370/976E

Form ID No. 021

1 From
Date 8-23-16
Sender's Name M. CHAFFEE Phone 928 680-5513
Company LSA CONSTRUCTION
Address 2750 CISCO DR S Dept./Floor/Suite/Room
City LAKE HAVASU CITY State AZ ZIP 86403-5110

2 Your Internal Billing Reference

3 To
Recipient's Name
Company BLM
Address ONE N CENTRAL We cannot deliver to PO boxes or P.O. ZIP codes. Dept./Floor/Suite/Room
Address SUITE 900 Use this line for the HOLD location address or for continuation of your shipping address.
City PHOENIX State AZ ZIP 85001



8070 6229 4839

4 Express Package Service *To most locations. NOTE: Service order has changed. Please select carefully.

Packages up to 150 lbs. For packages over 150 lbs., use the FedEx Express Freight US Airbill.

Next Business Day
 FedEx First Overnight Earliest next business morning delivery to select locations. Friday shipments will be delivered on Monday unless SATURDAY Delivery is selected.
 FedEx Priority Overnight Next business morning. *Friday shipments will be delivered on Monday unless SATURDAY Delivery is selected.
 FedEx Standard Overnight Next business afternoon. Saturday Delivery NOT available.

2 or 3 Business Days
 FedEx 2Day A.M. Second business morning. *Saturday Delivery NOT available.
 FedEx 2Day Second business afternoon. *Thursday shipments will be delivered on Monday unless SATURDAY Delivery is selected.
 FedEx Express Saver Third business day. *Saturday Delivery NOT available.

5 Packaging *Declared value limit \$500.
 FedEx Envelope* FedEx Pak* FedEx Box FedEx Tube Other

6 Special Handling and Delivery Signature Options
 SATURDAY Delivery NOT available for FedEx Standard Overnight, FedEx 2Day A.M., or FedEx Express Saver.
 No Signature Required Package may be left without obtaining a signature for delivery.
 Direct Signature Someone at recipient's address may sign for delivery. Fee applies.
 Indirect Signature If no one is available at recipient's address, someone at a neighboring address may sign for delivery. For residential deliveries only. Fee applies.

Does this shipment contain dangerous goods?
One box must be checked.
 Yes Shipper's Declaration not required.
 Dry Ice Dry Ice, 5 UN 1845 kg
 Cargo Aircraft Only

Enter FedEx Acct. No. or Credit Card No. below. Obtain receipt. Acct. No.
 Third Party Credit Card Cash/Check
Credit Card Auth.

Weight
lb. 3.23
kg 7.17
Unless you declare a higher value. See the current FedEx Service Guide for details.

HOLD
87:24
8:39
ST 4.2
R.T. 278
16:30
4839
D
AZ

fedex.com 1800.GoFedEx 1800.463.3339

Insert shipping document here.

FedEx
Express

earthsmart
FedEx carbon-neutral
envelope shipping

Align top of FedEx Express® shipping label here.

RECEIVED
BLM AZ STATE OFFICE
2016 AUG 25 P 1:23
PHOENIX, ARIZONA

Envelope

United States Department of the Interior
Bureau of Land Management
 DIV OF LANDS, MINRLS & ENERGY
 ONE N CENTRAL AVE
 PHOENIX, AZ 85004 -4427
 Phone: 602-417-9200

Receipt

No: 3642480

Transaction #: 3746438		ENTERED INTO COMPUTER
Date of Transaction: 08/26/2016		
CUSTOMER: <u>AC982(2017) B</u>		
MICHAEL M CHAFFEE 2750 CISCO DR S LAKE HAVASU CITY, AZ 86403-5110 US		

LINE #	QTY	DESCRIPTION	REMARKS	UNIT PRICE	TOTAL
1	1.00	LOCATABLE MINERALS / MINING CLAIMS- NOT NEW-UNADJUD, ONE AUTH NO. ONLY / MINING CLAIM MONEY RECEIVED CASES: AMC425567/\$620.00	MAINT FEE 2017 - 4	- n/a -	620.00
TOTAL:					\$620.00

PAYMENT INFORMATION			
1	AMOUNT:	620.00	POSTMARKED: 08/23/2016
	TYPE:	CHECK	RECEIVED: 08/25/2016
	CHECK NO:	1025	
	NAME:	AZURITE DEVELOPMENT CORPORATION 6175 PLUMTREE LANE EDMOND OK 73034 US	

REMARKS

This receipt was generated by the automated BLM Collections and Billing System and is a paper representation of a portion of the official electronic record contained therein.

Action Code Update

Serial-No: AMC432432

Status: CLOSED

Bottom of Screen

	Del?	Date (mm/dd/yyyy)	Code	Action Taken	Action Remark	Receipt Nr	Ins User	Mod User
<input checked="" type="radio"/> 1	<input type="checkbox"/> X	04/15/2015	403	LOCATION DATE			RMATTSON	REBERT
<input type="radio"/> 2	<input type="checkbox"/> X	05/18/2015	395	RECORDATION NOTICE RECD	1	3300271	CBS_IMPT	
<input type="radio"/> 3	<input type="checkbox"/> X	08/25/2014	782	MAINTENANCE FEE PAYMENT	2016;\$155	3377589	REBERT	
<input type="radio"/> 4	<input type="checkbox"/> X	08/20/2015	245	RECORDATION REJECTED	COUNTY RECORD PRE LOC		REBERT	RMYERS
<input type="radio"/> 5	<input type="checkbox"/> X	08/04/2015	669	LAND STATUS CHECKED			REBERT	
<input type="radio"/> 6	<input type="checkbox"/> X	05/18/2015	501	ACCT ADV IN LEAD FILE	AMC432432;		RMATTSON	
<input type="radio"/> 7	<input type="checkbox"/> X	05/18/2015	484	LOCATION YEAR / MAINTENANCE FEE	2015;\$155	3300271	RMATTSON	

Actions: 7

Provide me with new occurrences

Please SAVE&CONTINUE Between DELETES and NEW/CHANGE Lines

Serial-No: AMC432432

Top of Screen

DEPARTMENT OF THE INTERIOR
BUREAU OF LAND MANAGEMENT
MINING CLAIMS

MC Customer Information - With Serial No. and Claim Name
ACTIVE CLAIMS

Admin State: AZ
Geo State: AZ

CHAFFEE MICHAEL
2750 CISCO DR S
LAKE HAVASU CITY, AZ 86403-5110

CUSTOMER ID: 2324073

<u>Serial No.</u>	<u>Claim Name/Number</u>	<u>Lead Serial No.</u>	<u>Disposition</u>
AMC425567 ✓	SILVER CORD	AMC425567	ACTIVE
AMC425568 ✓	SILVER DOLLAR	AMC425567	ACTIVE
AMC425569 ✓	SILVER GATE	AMC425567	ACTIVE
→ AMC433889	GOLDEN SUN LODE	AMC433889	ACTIVE
→ AMC433890	GOLDEN SUN #2 LODE	AMC433889	ACTIVE

Number of ACTIVE cases: 5

→ Sending in this payment today 8/30/16; per my phone call, PB

*9/30/16 Michael C. called from 908. 493-2200 @ 3:33pm (Returning the call)
He is in a bit of a hurry to have been notified in person on 9/30/16.
He wanted the information on the status of his claims and asked
for the amount of payment he would need to pay for the claims.
I will have to check the payment amount.*

Customer Name Update Screen

System ID:MC

Name: CHAFFEE MICHAEL

Proprietor #: 2324073

Renumber To:

Category: P - PRIVATE

Address: 2750 CISCO DR S

City: LAKE HAVASU CITY

State: AZ

Zip: 864035110

UNDELIVERABLE

Email: worm@citlink.net *pk # & Email Address*

Phone: 928-680-5513

ENTERED AUG 30 2016

PB

Customer details successfully saved for Customer Id 2324073



Brown, Pauline <paulinebrown@blm.gov>

2017 Maintenance Fee Payment - Receipt #3642480

1 message

Brown, Pauline <paulinebrown@blm.gov>
To: wsrn@citlink.net

Tue, Aug 30, 2016 at 11:13 AM

To: Michael Chaffee,

Sir, the maintenance fee payment form we received on 8/25/16 only listed 4 claims, one of which was CLOSED in Aug 2015. You were sent a Decision notice dated 8/20/2015 explaining why AMC432432 (Golden Sun) which you listed on line 4, was closed.

I ran a mining claim customer service report on the name **CHAFFEE MICHAEL** today and the report listed 5 active claims.

The payment on receipt #3642480 was applied to 3 of the active claims listed on the form (#1-3) you submitted.

If you do not plan to keep the additional 2 active claims {AMC433889 & AMC433890} please send us a "Notarized relinquishment statement" so that we can close the two claims.

You may wish to make the additional payments via the pay portal. The pay portal will show you which claims are in Active status that have not yet been paid for. HOWEVER, in your case, we still have the \$155 payment which you attempted to apply towards AMC432432. You will need to inform us in writing (BEFORE 9/1/16) which claim you want the \$155 to be applied to, and then proceed to pay the other active claim via the pay portal or send in the additional \$155 payment along with the appropriate mining claim name and number before 9/1/16.

If you have any questions, please call. Please be reminded that the due date for the maintenance fee payments is this Thursday, September 1st.

-- PAULINE BROWN
LAND LAW EXAMINER
BUREAU OF LAND MANAGEMENT
ARIZONA STATE OFFICE
ONE NORTH CENTRAL AVE, STE 800
PHOENIX, AZ 85004-4427
OFFICE: (602) 417-9360
FAX: (602) 417-9490; 602-417-9452
paulinebrown@blm.gov
www.blm.gov/az
<https://www.facebook.com/BLMArizona>

Michael <wsrm@citlink.net>
To: "Brown, Pauline" <paulinebrown@blm.gov>

Tue, Aug 30, 2016 at 3:29 PM

Hi Pauline,

Attached is the letter you requested for your files. If I can be of any additional help please do not hesitate to contact me, and again, I appreciate your helping me fix a problem that I caused. We have corrected the yearly filing form to avoid the issue in the future.

Michael Chaffee

On 8/30/2016 11:13 AM, Brown, Pauline wrote:

[Quoted text hidden]

2 attachments

 **BLM Fee Pay correct error MMC 83016.doc**
33K

*PRINTED
See Attached
PB*

 **wasm.vcf**
1K



Brown, Pauline <paulinebrown@blm.gov>
To: Michael <wsrm@citlink.net>

Tue, Aug 30, 2016 at 3:47 PM

Thank you. Glad I can be of assistance.

Regards,

[Quoted text hidden]



Brown, Pauline <paulinebrown@blm.gov>

2017 Maintenance Fee Payment - Receipt #3642480

4 messages

Brown, Pauline <paulinebrown@blm.gov>
To: wsm@citlink.net

Tue, Aug 30, 2016 at 11:13 AM

To: Michael Chaffee,

Sir, the maintenance fee payment form we received on 8/25/16 only listed 4 claims, one of which was CLOSED in Aug 2015. You were sent a Decision notice dated 8/20/2015 explaining why AMC432432 (Golden Sun) which you listed on line 4, was closed.

I ran a mining claim customer service report on the name **CHAFFEE MICHAEL** today and the report listed 5 active claims.

The payment on receipt #3642480 was applied to 3 of the active claims listed on the form (#1-3) you submitted.

If you do not plan to keep the additional 2 active claims {AMC433889 & AMC433890} please send us a "Notarized relinquishment statement" so that we can close the two claims.

You may wish to make the additional payments via the pay portal. The pay portal will show you which claims are in Active status that have not yet been paid for. HOWEVER, in your case, we still have the \$155 payment which you attempted to apply towards AMC432432. You will need to inform us in writing (BEFORE 9/1/16) which claim you want the \$155 to be applied to, and then proceed to pay the other active claim via the pay portal or send in the additional \$155 payment along with the appropriate mining claim name and number before 9/1/16.

If you have any questions, please call. Please be reminded that the due date for the maintenance fee payments is this Thursday, September 1st.

-- PAULINE BROWN
LAND LAW EXAMINER
BUREAU OF LAND MANAGEMENT
ARIZONA STATE OFFICE
ONE NORTH CENTRAL AVE, STE 800
PHOENIX, AZ 85004-4427
OFFICE: (602) 417-9360
FAX: (602) 417-9490; 602-417-9452
paulinebrown@blm.gov
www.blm.gov/az
<https://www.facebook.com/BLMArizona>

Michael <wsm@citlink.net>
To: "Brown, Pauline" <paulinebrown@blm.gov>

Tue, Aug 30, 2016 at 3:23 PM

[Quoted text hidden]

wsm.vcf
1K

Michael M. Chaffee.

2750 Cisco Drive South, LAKE HAVASU CITY, ARIZONA 86403

TEL: (928) 680-5513 . FAX: (928) 680-7066

E-MAIL: wsrcm@citlink.net or www.westernsierramining.com

30 August, 2016

TRANSMITTAL LETTER

TO: Bureau of Land Management
One N. Central Ave. Suite 800
Phoenix, Arizona 85004-4427

Attn. Pauline Brown

This will confirm our conversation this date regarding the Claim Golden Sun AMC #433889. In our filing of August 22, 2016, we provide an incorrect number for the active claim so identified. The incorrect number was 432432 which was previously declared "In active".

In addition, we paid separately for the claim Golden Sun 2 via FedX tracking # 8070-6229-4986 on August 25, 2016. *✶ - see attached tracking report. ps*

Pauline, we greatly appreciate your catching this error on our part and allowing us correct it in this manner. If there is any additional information or clarification for me, please do not hesitate to contact me directly.

As always, thank you again for your assistance in this matter,

Sincerely,

Michael Chaffee

Michael M. Chaffee

My Profile | Support | Locations | English | Search or tracking number | Sub



Shipping | Tracking | Manage | Learn | FedEx Office®

Login

IMPORTANT!

FedEx is closely monitoring Tropical Depression Eight, Tropical Depression Nine, Hurricane Lester, and Hurricane Madeline. [Learn More](#)

FedEx® Tracking

807062294986

Ship date:

Thu 8/25/2016

Actual delivery:

Tue 8/30/2016 10:40 am

LAKE HAVASU CITY, AZ
US

Delivered

Signed for by: E.EUGINE

AZ US

8/30/16

Travel History

Date/Time	Activity	Location
- 8/30/2016 - Tuesday		
10:40 am	Delivered	AZ
8:32 am	On FedEx vehicle for delivery	PHOENIX, AZ
7:17 am	At local FedEx facility	PHOENIX, AZ
- 8/29/2016 - Monday		
8:31 am	At local FedEx facility	PHOENIX, AZ
7:32 am	At local FedEx facility	PHOENIX, AZ
6:53 am	Package not due for delivery	PHOENIX, AZ
- 8/26/2016 - Friday		
9:02 am	At local FedEx facility	PHOENIX, AZ
7:32 am	At local FedEx facility	PHOENIX, AZ
7:27 am	Package not due for delivery	PHOENIX, AZ
- 8/25/2016 - Thursday		
6:33 pm	At destination sort facility	PHOENIX, AZ
5:33 pm	Left FedEx origin facility	LAKE HAVASU CITY, AZ
3:55 pm	Picked up	LAKE HAVASU CITY, AZ

Shipment Facts

Tracking number	807062294986	Service	FedEx Express Saver
Delivered To	Receptionist/Front Desk	Total pieces	1
Terms	Shipper	Packaging	FedEx Envelope
Special handling section	Deliver Weekday	Standard transit	8/30/2016 by 4:30 pm



Search or tracking number | Sub

Customer Focus

New Customer Center
Small Business Center
Service Guide
Customer Support

Featured Services

FedEx Delivery Manager
FedEx SameDay
FedEx Home Delivery
FedEx TechConnect
Healthcare Solutions

Companies

FedEx Express
FedEx Ground
FedEx Office
FedEx Freight
FedEx Custom Critical

Follow FedEx

United States - English

Company Information

[About FedEx](#)
[Careers](#)
[Investor Relations](#)
[Subscribe to FedEx email](#)

Online Retail Solutions

[Packaging Services](#)
[Ancillary Clearance Services](#)

FedEx Trade Networks

[FedEx CrossBorder](#)
[FedEx SupplyChain](#)

Other Resources

[FedEx Compatible Developer Resource Center](#)
[FedEx Ship Manager Software](#)
[FedEx Mobile](#)

MINING CLAIMS

MC Customer Information - With Serial No. and Last Assessment Code

ACTIVE CLAIMS

Page 1 of 1

Admin State: AZ

Geo State: AZ

CHAFFEE MICHAEL
2750 CISCO DR S
LAKE HAVASU CITY, AZ 86403-5110

CUSTOMER ID: 2324073

<u>Serial No.</u>	<u>Claim Name/Number</u>	<u>Last Assmt Code</u>	<u>Last Assmt YR</u>	<u>Disposition</u>
AMC425567 ✓	SILVER CORD	782	2017	ACTIVE
AMC425568 ✓	SILVER DOLLAR	782	2017	ACTIVE
AMC425569 ✓	SILVER GATE	782	2017	ACTIVE
AMC433889 ✓	GOLDEN SUN LODE	484	2016	ACTIVE
AMC433890	GOLDEN SUN #2 LODE	484	2016	ACTIVE

Number of ACTIVE cases: 5

*(✓) paid for on R# 3642480 on 8/25/16.**(-) paid for on R# 3647834 on 8/30/16**pb*

425567

432432

Michael M. Chaffee.

2750 Cisco Drive South, LAKE HAVASU CITY, ARIZONA 86403

TEL: (928) 680-5513 . FAX: (928) 680-7066

E-MAIL: wsrcm@citlink.net or www.westernsierramining.com

21 August, 2015

TRANSMITTAL LETTER

TO: Bureau of Land Management
One N. Central Ave. Suite 800
Phoenix, Arizona 85004-4427

Please find enclosed our check number 1015 in the amount of \$620.00 for our Maintenance Fee Payment on the attached listed 4 mining claims for the period 2015-2016.

We have enclosed a return stamped envelope so you could provide us with a certified copy.

As always, thank you for your assistance in this matter,

Sincerely,

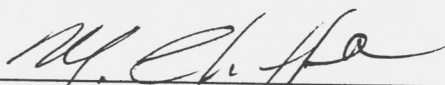

Michael M. Chaffee

RECEIVED
BLM AZ STATE OFFICE
2015 AUG 25 A 10:33
PHOENIX, ARIZONA

ENTERED
AUG 28 2015
BY: RE

ARIZONA

CALIFORNIA

IDAHO

MEXICO

BAJA CALIFORNIA

MAINTENANCE FEE PAYMENT

Claimant Name: Michael M. Chaffee
 Address: 2750 Cisco Drive South
 City: Lake Havasu City State: AZ Zip: 86403
 Telephone: 928-680-5513
 E-mail address: worm@citlink.net

Signature: *Michael M. Chaffee*

(This is not a change of address)

RECEIVED
 BLM AZ STATE OFFICE
 2015 AUG 25 A 10:33
 PHOENIX, ARIZONA

BLM
 Date
 Stamp

Line No.	AMC Number	Claim/site Name	County Recorder Data	TWP	RNG	SEC
1	425567	Silver Cord	2014-0035137	11N	01E	36
2	425568	Silver Dollar	2014-0035137	11N	01E	36
3	425569	Silver Gate	2014-0035137	10N	02E	7
4	432432	Golden Sun	2015-0016463	11N	01W	9
5						
6						
7						
8						
9						

Bureau of Land Management
 Arizona State Office
www.az.gov

No. of Claims: 4 x \$155 = \$620.00

Check No.: 1015

Receipt No.: 3377589

For BLM Use Only

MAINTENANCE FEE PAYMENT

Claimant Name: Michael M. Chaffee
 Address: 2750 Cisco Drive South
 City: Lake Havasu City State: AZ Zip: 86403
 Telephone: 928-680-5513
 E-mail address: wasm@citlink.net

Signature: *M. Chaffee*
 (This is not a change of address)

RECEIVED
 BLM AZ STATE OFFICE
 PHOENIX, ARIZONA
 2015 AUG 25 A 10:33
 BLM
 Date
 Stamp

Line No.	AMC Number	Claim/site Name	County Recorder Data	TWP	RNG	SEC
1	425567	Silver Cord	2014-0035137	11N	01E	36
2	425568	Silver Dollar	2014-0035137	11N	01E	36
3	425569	Silver Gate	2014-0035137	10N	02E	7
4	432432	Golden Sun	2015-0016463	11N	01W	9
5						
6						
7						
8						
9						

Bureau of Land Management
 Arizona State Office
www.az.gov

No. of Claims: 4 x \$155 = \$620.00

Check No.: 1018

Receipt No: _____

For BLM Use Only

Do not ship liquids, blood, or biologics in this packaging.

88 ZSYA

85004
AZ-US
PHX



00022B 28AUG16 THU 537CL/TC/FE48

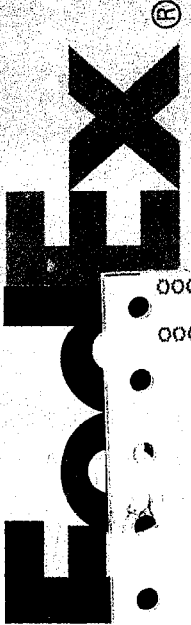

RT 275
ST 11.2
3 16:30
D 5044
08.25

00022B
0002B

FedEx Package
Express US Airbill

FedEx Tracking Number 8070 6229 5044

1 From
Date 8-24-16
Sender's Name M. CHAFFEE Phone 928 680-5513
Company LSA CONSTRUCTION
Address 2750 CISCOR DR S
City LAKE HAVASU CITY State AZ ZIP 86403-8110

2 Your Internal Billing Reference

3 To Recipient's Name BLM Phone

Company BUREAU OF LAND MANAGEMENT

Address ONE NORTH CENTRAL

Address SUITE 800

City PHOENIX State AZ ZIP 85004

0117902715



8070 6229 5044

fedex.com 1.800.GoFedEx 1.800.463.3339

fedex.com 1.800.GoFedEx 1.800.463.3339

0215 16 minutes Day

4 Express Package Service
NOTE: Service order has changed. Please select carefully.
Next Business Day
FedEx First Overnight
FedEx Priority Overnight
FedEx Standard Overnight
2 or 3 Business Days
FedEx 2Day A.M.
FedEx 2Day
FedEx Express Saver

5 Packaging
FedEx Envelope* FedEx Pak* FedEx Box FedEx Tube Other

6 Special Handling and Delivery Signature Options
SATURDAY Delivery
No Signature Required
Direct Signature
Indirect Signature
Does this shipment contain dangerous goods?

7 Payment Bill to:
Sender Recipient Third Party Credit Card Cash/Check

Total Packages Total Weight Credit Card Auth.

Rev. Date 2/12 • Part #16134 • ©1994-2012 FedEx • PRINTED IN U.S.A. 51F

Insert shipping document here.

FedEx
Express

earthsmart
FedEx carbon-neutral
envelope shipping

Align top of FedEx Express® shipping label here.

Envelope

RECEIVED
BLMAZ STATE OFFICE
2015 AUG 25 A 10: 29
PHOENIX, ARIZONA

Align bottom of peel and stick airbill here.

United States Department of the Interior
Bureau of Land Management
LANDS/RECREATION & PLANNING
ONE N CENTRAL AVE
PHOENIX, AZ 85004 -2203
Phone: 602-417-9200

Receipt

No: 3377589

Transaction #: 3475839	
Date of Transaction: 08/26/2015	
CUSTOMER:	
MICHAEL M CHAFFEE 2750 CISCO DR S LAKE HAVASU CITY, AZ 86403-5110 US	

LINE #	QTY	DESCRIPTION	REMARKS	UNIT PRICE	TOTAL
1	1.00	LOCATABLE MINERALS / MINING CLAIMS- NOT NEW-UNADJUD, ONE AUTH NO. ONLY / MINING CLAIM MONEY RECEIVED CASES: AMC425567/\$620.00	MAINT FEE PYMNT - 4 2016	- n/a -	620.00
TOTAL:					\$620.00

PAYMENT INFORMATION				
1	AMOUNT:	620.00	POSTMARKED:	08/21/2015
	TYPE:	CHECK	RECEIVED:	08/25/2015
	CHECK NO:	1015		
	NAME:	AZURITE DEVELOPMENT CORPORATION 6175 PLUMTREE LANE EDMOND OK 73034 US		

REMARKS

This receipt was generated by the automated BLM Collections and Billing System and is a paper representation of a portion of the official electronic record contained therein.

425567

MAINTENANCE FEE PAYMENT

Claimant Name: MICHAEL CHAFFEE
Address: 2750 CISCO DR SOUTH
City: LAKE HAVAS State: AZ Zip: 86403
Telephone: 928-680-5513
E-mail address: MUSRIM@CITLINK.NET
Signature: [Signature]

Check here if this is a change of address.

BLM
Date
Stamp
2014 AUG 20 A 9:25
PHOENIX, ARIZONA
BLMAZ STATE OFFICE
RECEIVED

LINE NO.	AMC NUMBER	CLAIM/SITE NAME	COUNTY RECORDER DATA (If available)	TWP	RNG	SEC
1	425567	SILVER CORD	2014-0035137	11N	01E	36
2	425568	SILVER DOLLAR	"	11N	01E	36
3	425569	SILVER GATE	"	10N	02E	7
4						
5						
6						
7						
8						
9						
10						

List additional claims on Form MCF114.

Bureau of Land Management
Arizona State Office
www.az.blm.gov

No. of Claims: 3 x \$155 = 465.00
Check No: 7910 Init. AA
Receipt No.: 3107998
For BLM Use Only

Form: MCF112
Revised July 2005

This form is available from the Arizona Department of Mines and Mineral Resources and may be reproduced.

ENTERED
AUG 26 2014
BY: RS

LSA Construction.

2750 Cisco Drive South, LAKE HAVASU CITY, ARIZONA 86403
TEL: (928) 680-5513 . FAX: (928) 680-7066
E-MAIL: wsm@citlink.net

16 August, 2014

TRANSMITTAL LETTER

TO: Bureau of Land Management
One N. Central Ave. Suite 800
Phoenix, Arizona 85004-4427

Please find enclosed our check number 7910 in the amount of \$ 465.00 for our Maintenance Fee Payment on the attached listed 3 mining claims for the period 2014-2015.

We have enclosed a return stamped envelope so you could provide us with a certified copy.

As always, thank you for your assistance in this matter,

Sincerely,

Michael M. Chaffee

RECEIVED
BLM AZ STATE OFFICE
2014 AUG 20 A 9:25
PHOENIX, ARIZONA

United States Department of the Interior
Bureau of Land Management
 LANDS/RECREATION & PLANNING
 ONE N CENTRAL AVE
 PHOENIX, AZ 85004 -2203
 Phone: 602-417-9200

Receipt

No: 3107998

Transaction #: 3199663	
Date of Transaction: 08/21/2014	
CUSTOMER:	
LSA CONSTRUCTION 2750 CISCO DR S LAKE HAVASU CITY, AZ 86403-5110 US	

LINE #	QTY	DESCRIPTION	REMARKS	UNIT PRICE	TOTAL
1	1.00	LOCATABLE MINERALS / MINING CLAIMS- NOT NEW-UNADJUD, ONE AUTH NO. ONLY / MINING CLAIM MONEY RECEIVED CASES: AMC425567/\$465.00	MAINT FEE PYMNT (3) 2015	- n/a -	465.00
TOTAL:					\$465.00

PAYMENT INFORMATION					
1	AMOUNT:	465.00	POSTMARKED:	08/19/2014	
	TYPE:	CHECK	RECEIVED:	08/20/2014	
	CHECK NO:	7910			
	NAME:	LSA CONSTRUCTION 2750 CISCO DR S LAKE HAVASU CITY AZ 86403-5110 US			

REMARKS

This receipt was generated by the automated BLM Collections and Billing System and is a paper representation of a portion of the official electronic record contained therein.

Amc 425567

When Recorded Return Document to:
DIANA HANS
19701 E. SQUAW VALLEY PKWY.
BLACK CANYON CITY, AZ. 85324

Check here is this is a change of address.

Telephone: 623-374-5504

E-mail address: AZLADY909@MSN.COM

AFFIDAVIT OF PERFORMANCE OF ANNUAL WORK

1. State of Arizona, County of YAVAPAI ss:

2. I (Name) DIANA HANS / RICHARD CARTER

3. Reside at (Address) _____

19701 E. SQUAW VALLEY PKWY

City BLACK CANYON CITY County YAVAPAI

State AZ Zip 85324 being duly sworn, depose and say that I am a citizen of the United States, more than eighteen years of age, and that all of the facts set forth in this affidavit, subject to the provisions and penalties of 18 U.S.C. 1001 pertaining to the filing of false, fictitious, or fraudulent statements with the United States, are true and correct according to the best of my knowledge, information and belief.

4. Owner's name and address (If not shown in Items 1-3 above). _____

5. That I am personally acquainted with the mining claim(s). The work and improvements were made by and at the expense of the owner(s) of said claim(s). Said contiguous group of claims, listed on this document, are situated in the

_____ (optional) Mining District; _____ County, Arizona.

RECEIVED
AZ STATE OFFICE
2014 AUG - 4 A 10: 03
PHOENIX, ARIZONA
BLM
Date
Stamp

Line No.	AMC NUMBER	CLAIM/SITE NAME	COUNTY RECORDER DATA (If available)	TWP	RNG	SEC
1	425567	Silver CORD		0110N	0010E	36
2	425568	Silver DOLLAR		0111N	001E	36
3	425569	Silver GATE		010N	002E	7
4						
5						
6						

INTERESTED
AUG - 5 2014
BY: RHM

RECEIVED
BLM AZ STATE OFFICE

2014 AUG - 4 A 10: 03
PHOENIX, ARIZONA

BLM
Date
Stamp

7						
8						
9						
10						

6. That between the dates starting at 12 o'clock noon on September 1, 20 13 and ending at 12 o'clock noon on September 1, 20 14 at least \$ 1600⁰⁰ dollars worth of work and improvements were done and performed upon said claim(s) or upon one or more of a contiguous group of claims for the benefit of all, wholly or partly outside of a contiguous group of claims for the benefit of all, not including the location work.

7. That the following persons were employed to perform the work and improvements described herein: Richard CARTER, DIANA HAAS, BRETT White

8. That the work and improvements performed were: ROAD WORK FOR MINE ACCESS, NEW LOCKS, IRON DOOR FOR MINE ENTRANCE (EXISTING VANDALIZED, SHOT) FOR SAFETY, NEW SHORING IN MINE @ 50', 150', 200' INSIDE SHAFT. ADDITIONAL LIGHTING, INSTALLED

9. Dated: 7/24/14 Signature: Diana Haas

SUBSCRIBED AND SWORN TO before me, a Notary Public, this 24th day of July, 2014

By: Diana Haas Richard White

Notary Public: Kristen M Taylor

My Commission Expires January 25, 2016



Bureau of Land Management
Arizona State Office
www.az.blm.gov

No. of Claims: 3 x \$10 = 30

Check No.: CC Init. ML

Receipt No.: 3092047

For BLM Use Only

INDIVIDUAL ACKNOWLEDGMENT

State/Commonwealth of Michigan }
County of Roscommon } ss.

On this the 28th day of July, 2014, before me,
Jessica Spindler, the undersigned Notary Public,
Day Month Year
Name of Notary Public
personally appeared Richard Carter,
Name(s) of Signer(s)

personally known to me - OR -

proved to me on the basis of satisfactory evidence

to be the person(s) whose name(s) is/are subscribed to the within instrument, and acknowledged to me that he/she/they executed the same for the purposes therein stated.

WITNESS my hand and official seal.

Jessica Spindler
Signature of Notary Public

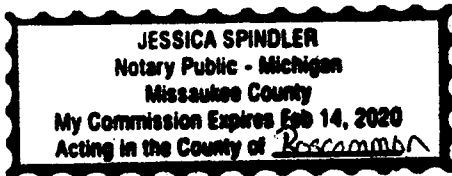

Place Notary Seal/Stamp Above

Any Other Required Information
(Printed Name of Notary, Expiration Date, etc.)

RECEIVED
M A Z STATE OFFICE
2014 AUG - 4 10:03
PHOENIX, ARIZONA

OPTIONAL

This section is required for notarizations performed in Arizona but is optional in other states. Completing this information can deter alteration of the document or fraudulent reattachment of this form to an unintended document.

Description of Attached Document

Title or Type of Document: Affidavit of Performance of Annual Work
Document Date: 7/24/2014 Number of Pages: 2
Signer(s) Other Than Named Above: Diana Hans

United States Department of the Interior
Bureau of Land Management
 LANDS/RECREATION & PLANNING
 ONE N CENTRAL AVE
 PHOENIX, AZ 85004 -2203
 Phone: 602-417-9200

ENTERED
 AUG - 5 2014
 BY: *[Signature]*

Receipt

No: 3092047

Transaction #: 3183451
Date of Transaction: 08/04/2014
CUSTOMER:
DIANA HANS 19701 E SQUAW VALLEY PKWY BLACK CANYON CITY, AZ 85324-8638 US

LINE #	QTY	DESCRIPTION	REMARKS	UNIT PRICE	TOTAL
1	1.00	LOCATABLE MINERALS / MINING CLAIMS- NOT NEW-UNADJUD, ONE AUTH NO. ONLY / MINING CLAIM MONEY RECEIVED CASES: AMC425567/\$30.00	POL 2014/3	- n/a -	30.00
TOTAL:					\$30.00

PAYMENT INFORMATION			
NOTE: Items will appear on credit card statement as "Bureau of Land Mgmt CO".			
1	AMOUNT:	30.00	POSTMARKED: N/A
	TYPE:	CREDIT CARD	RECEIVED: 08/04/2014
	NAME:	HANS, DIANA 19701 E SQUAW VALLEY PKWY BLACK CANYON CITY AZ 85324-8638 US	
	CARD NO:	XXXXXXXXXXXX7418	AUTH CODE: 080613
	NAME ON CARD:	DIANA L HANS	
	EXPIRES:	04/2017	
	SIGNATURE:		

REMARKS

This receipt was generated by the automated BLM Collections and Billing System and is a paper representation of a portion of the official electronic record contained therein.

NOTICE!!

These documents have been scanned!

Do not place un-scanned documents beneath this notice!

Do not remove this notice from this file!

GPO Jacket No. 560-102
Print Order 61540
Rise Business Services, LLC
Job=AZ15 5/10/2019



Box Number= AZ15036



Claim Begin-End: AMC425567-AMC425569

6 Location Notices-Amendments and Supporting Documents



AZ15036-23

AMC425096-AMC425592

**DEPARTMENT OF THE INTERIOR
BUREAU OF LAND MANAGEMENT
MINING CLAIMS**

Run Date/Time: 12/12/2013 09:22 AM

(LIVE) Serial Register Page

Page 1 of 1

01 05-10-1872;017STAT0091;30USC26,28,34
Case Type 384101: LODE CLAIM
Claim Name: SILVER GATE
Commodity :
Case Disposition: ACTIVE
Required Maintenance Fee: \$140.00

Total Acres
20.660

Serial Number
AMC425569
Lead File Number
AMC425567

Name & Address	Int Rel
HANS DIANA 19701 E SQUAW VALLEY PKWY	BLACK CANYON CITY, AZ 85324-863 CLAIMANT
CARTER RICHARD W PO BOX 397, 19701 E SQUAW VALLEY PKWY	BLACK CANYON CITY, AZ 85324-039 CLAIMANT

Mer Twp	Rng	Sec	Quadrant	District/Field Office	County
14	0110N	0010E	036 NE	HASSAYAMPA FO	YAVAPAI
14	0110N	0020E	007 NW SW	HASSAYAMPA FO	YAVAPAI

Act Date	Code	Action	Action Remarks	Receipt Number
12/04/2013	403	LOCATION DATE		
12/05/2013	395	RECORDATION NOTICE RECD	1	2924902
12/05/2013	484	LOCATION YEAR / MAINTENANC	2014;\$140	2924902
12/05/2013	501	ACCT ADV IN LEAD FILE	AMC425567-AMC425569;	

Line Nr Remarks

LLP Needs to be corrected.

AB

**DEPARTMENT OF THE INTERIOR
BUREAU OF LAND MANAGEMENT
MINING CLAIMS**

(LIVE) Serial Register Page

Run Date/Time: 12/12/2013 09:20 AM

Page 1 of 1

01 10-21-1976;090STAT0090;43USC1744
Case Type 384201: PLACER CLAIM
Claim Name: SILVER DOLLAR
Commodity :
Case Disposition: ACTIVE
Required Maintenance Fee: \$140.00

Total Acres
20.000

Serial Number
AMC425568
Lead File Number
AMC425567

Name & Address			Int	Rel
HANS DIANA	19701 E SQUAW VALLEY PKWY	BLACK CANYON CITY, AZ 85324-863	CLAIMANT	
CARTER RICHARD W	PO BOX 397, 19701 E SQUAW VALLEY PKWY	BLACK CANYON CITY, AZ 85324-039	CLAIMANT	

Mer Twp	Rng	Sec	Quadrant	District/Field Office	County
14	0110N	0010E	036 NE,NW ,SW ,SE	HASSAYAMPA FO	YAVAPAI

Act Date	Code	Action	Action Remarks	Receipt Number
12/04/2013	403	LOCATION DATE		
12/05/2013	395	RECORDATION NOTICE RECD	1	2924902
12/05/2013	484	LOCATION YEAR / MAINTENANC	2014;\$140	2924902
12/05/2013	501	ACCT ADV IN LEAD FILE	AMC425567-AMC425569;	

Line Nr Remarks

**DEPARTMENT OF THE INTERIOR
BUREAU OF LAND MANAGEMENT
MINING CLAIMS**

Run Date/Time: 12/12/2013 09:16 AM

(LIVE) Serial Register Page

Page 1 of 1

01 05-10-1872;017STAT0091;30USC26,28,34
Case Type 384101: LODE CLAIM
Claim Name: SILVER CORD
Commodity :
Case Disposition: ACTIVE
Required Maintenance Fee: \$140.00

Total Acres
20.660

Serial Number
AMC425567
Lead File Number
AMC425567

Name & Address	Int Rel
HANS DIANA CARTER RICHARD W	19701 E SQUAW VALLEY PKWY PO BOX 397, 19701 E SQUAW VALLEY PKWY
	BLACK CANYON CITY, AZ 85324-863 CLAIMANT BLACK CANYON CITY, AZ 85324-039 CLAIMANT

Mer Twp	Rng	Sec	Quadrant	District/Field Office	County
14	0110N	0010E	036	NE	HASSAYAMPA FO
					YAVAPAI

Act Date	Code	Action	Action Remarks	Receipt Number
12/04/2013	403	LOCATION DATE		
12/05/2013	395	RECORDATION NOTICE RECD	1	2924902
12/05/2013	484	LOCATION YEAR / MAINTENANC	2014;\$140	2924902
12/05/2013	501	ACCT ADV IN LEAD FILE	AMC425567-AMC425569;	

Line Nr Remarks

MINING CLAIM STATUS REPORT

Data Entered: 12/12/13 DM

MTP Checked By: PB
GEO Checked By: PB

LEAD SERIAL NUMBER: AMC 425567 thru AMC 425569

NUMBER OF CLAIMS & TYPE:

2 ~~3~~ LODE
1 PLACER
ASSOCIATION PLACER
MILL SITE
TUNNEL SITE

CHARGES:

Location Fee @ \$34 = \$ 102
Processing Fee @ \$20 = \$ 60
Maintenance Fee @ \$140 = \$ 420
Add'l Maint Fee for Assoc Placer = \$
SUBTOTAL \$
Other Fees \$
Other Fees \$
TOTAL \$ 582

TOTAL ACREAGE: _____ Per Claim
(Placer Only)

NUMBER OF LOCATORS: _____

DOCUMENTS RECEIVED VIA: Over-the-Counter [] Mail [] **TIMELY FILED:** Yes [] No []

LEGAL DESCRIPTION: T 11N R 1E SEC 36
~~T 11N R 2E SEC 7~~
T 10N R 2E SEC 7
T _____ R _____ SEC _____
T _____ R _____ SEC _____

BLM [] FOREST SERVICE [] Prescott SUBJ TO PL 359: Yes [] No []
WILDERNESS AREA []

SPLIT ESTATE: N/A [] SX [] PX [] OTHER []
SRHA [] Was proper Notice filed if located on SHRA Land? Yes [] No []

RECONVEYED MINERALS ON BLM LAND REQUIRE OPENING ORDER FROM 1944 TO 1993:
Open to Entry On _____ N/A []

COMMENTS/STATUS: VOID [] PARTIALLY VOID [] PVT MINERALS [] WITHDRAWN LANDS []
OTHER [] _____

[] Claimant acknowledges that portions of the following claim(s) site(s) may be void or voidable.

Printed Name of Claimant _____ Signature of Claimant _____

*****FINAL ADJUDICATION*****
DATE MAR 20, 2014 INITIALS PB

AMC 425567

LOCATION NOTICE FOR LODE MINING CLAIM

NOTICE IS HEREBY GIVEN that the SILVER CORD

_____ lode mining claim has been located

by Richard W. CARTER / whose current mailing
DIANA L. HANS
address is _____

19701 E. SQUAW VALLEY Pkwy.
BLACK CHANON CITY, AZ. 85324.

RECEIVED
BLM AZ STATE OFFICE
2013 DEC -5 P 1:52
PHOENIX, ARIZONA
BLM
Date
Stamp

The general course of this claim is SW TO NE and it is situated in YAVAPAI
County, Arizona. This claim is 1500 feet in length and 600^{20.66} feet in width. This claim runs
from the location monument on which this location notice is posted approximately 300 feet in a
SE direction to the E end line and 300 feet in a NW direction to the
W end line. This claim is marked by six monuments, one at each corner and one at the center of each
end line of the claim.

The location monument on which this notice is posted is situated within Section 36, Township 11N
_____, Range 01 E, Gila Salt River Base and Meridian, Arizona and this claim encompasses portions
of the following quarter section (s), section (s), Township (s) and Range (s) NE 1/4 sec 36
T11N, R01E

Gila Salt River Base and Meridian, Arizona.

The locality of this claim with reference to some natural object or permanent monument and additional information
(if any) concerning its locality are as follows: 1 mile south of Townsend
BUTTE

DATED AND POSTED on the ground this 4 day of Dec, 2013.

LOCATOR (s) RICHARD W. CARTER

DIANA L. HANS
Richard W. Carter Diana L. Hans

ENTERED
DEC 12 2013
Form MCF100
Revised July 2005
BY: M

AMC425567

MINING CLAIM MAP

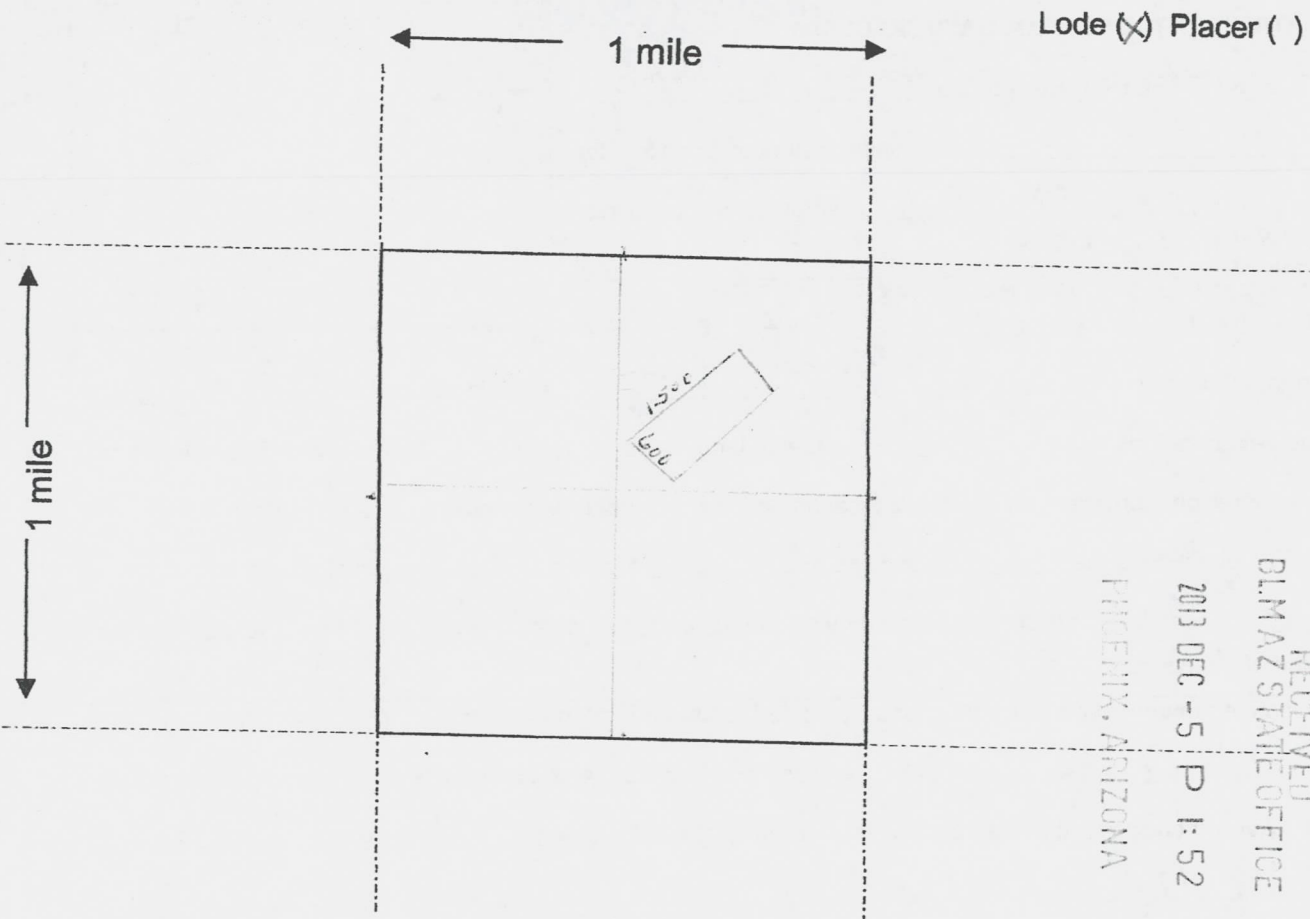

Scale : 1" = 2000 feet



1. The above map depicts the Silver Cord mining claim, which is located in Section (s) 36, Township 11 N, Range 01 E, Gila and Salt River Base and Meridian, YAVAPAI County, Arizona.

2. The type of corner and location monuments used are as follows: 4" sq. white 4 ft. wooden posts

3. The bearings and distances in degrees and feet between claim corners are as depicted on the map.

Form MCF100a
Revised July 2005

This form is available from the Arizona Department of Mines & Mineral Resources and may be reproduced.

RECEIVED
BLM AZ STATE OFFICE

2013 DEC - 5 P 1:52

PHOENIX, ARIZONA

BLM Date Stamp

LOCATION NOTICE FOR PLACER MINING CLAIM

NOTICE IS HEREBY GIVEN that the SILVER Dollar

placer mining claim has been located by
RICHARD W. CARTER -
DIANA L. HANS whose current mailing
address is 19701 E. SQUAW VALLEY PKWY.
BLACK CANYON CITY, AZ, 85324.

The general course of this claim is N TO S and it is situated in
YAVAPAI County, Arizona.

This claim is 1320 feet in length and 660 feet in width. This claim runs from the
location monument on which this location notice is posted approximately 1320 feet in a Southerly
direction to the South end line and 660 feet in a West direction to the West end line.

This claim is marked by four monuments, one at each corner of the claim.

The location monument on which this notice is posted is situated within Section 36, Township
11 N, Range 01 E, Gila Salt River Base and Meridian, Arizona. This claim encompasses

portions of the following legal subdivision(s) if located by legal subdivision or the following quarter section (s),
section (s), Township (s) and Range (s) NE 1/4 SW 1/4 Sec 36 T11N R01E, NW 1/4 SE 1/4 Sec 36 T11N R01E
SE 1/4 NW 1/4 Sec 36 T11N R01E
SW 1/4 NE 1/4 Sec 36 T11N R01E, Gila Salt River Base and Meridian, Arizona.

The locality of this claim with reference to some natural object or permanent monument and additional
information (if any) concerning its locality are as follows: TURKEY CREEK
Below Silver Cord Mine

DATED AND POSTED on the ground this 4 day of Dec, 2013.

LOCATOR (s) Richard W. Carter / DIANA L. HANS
Richard W. Carter Diana L. Hans

Form MCF102
Revised July 2005

This form is available from the Arizona Department of Mines & Mineral Resources and may be reproduced.

DEC 12, 2013
BY: KMA

ANCI425568

MINING CLAIM MAP

Lode () Placer (X)

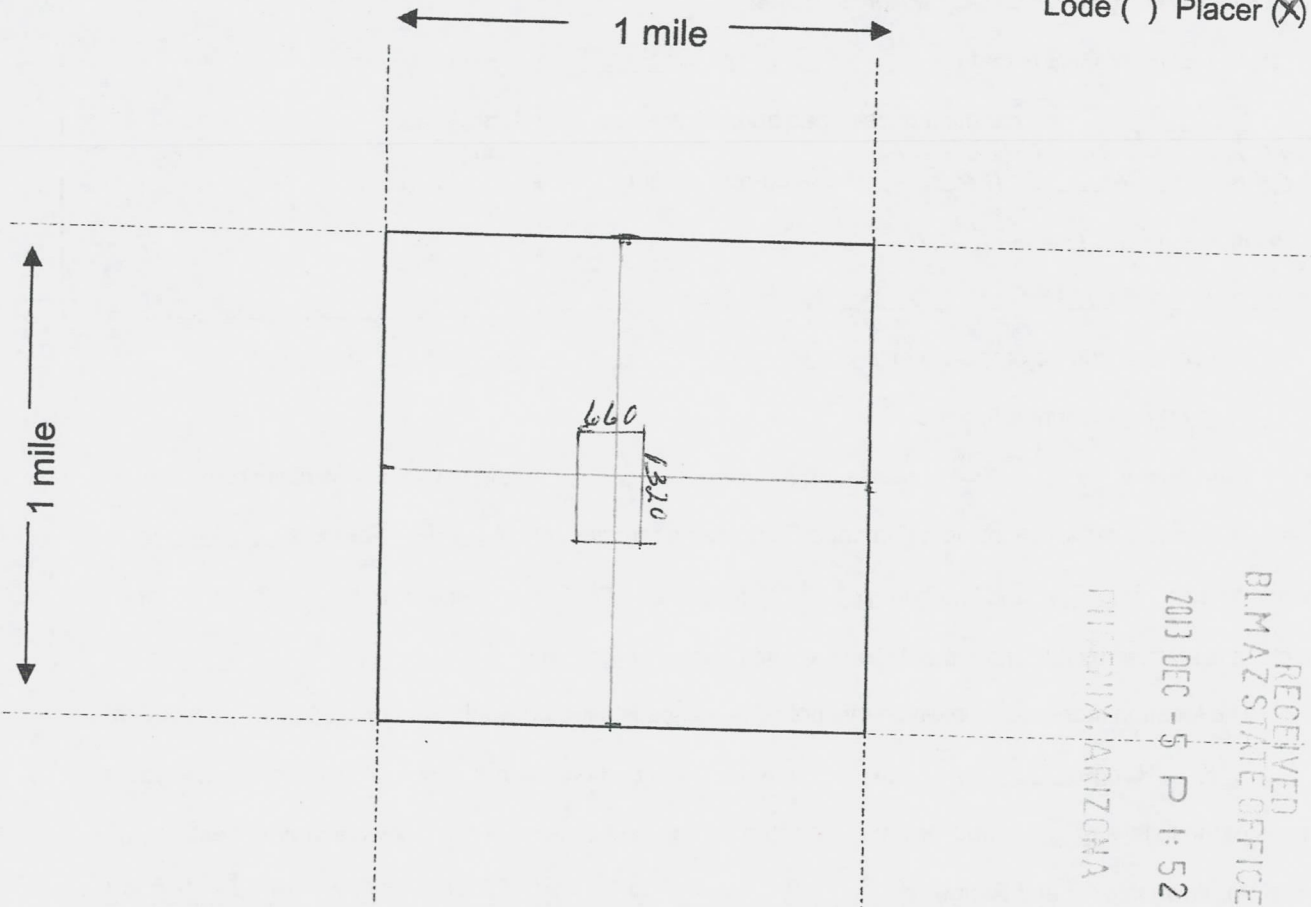

RECEIVED
BLM AZ STATE OFFICE
2013 DEC - 5 P 1:52
PHOENIX, ARIZONA

Scale : 1" = 2000 feet



1. The above map depicts the Silver Dollar mining claim, which is located in Section (s) 36, Township 11 N, Range 01 E, Gila and Salt River Base and Meridian, YAVAPAI County, Arizona.
2. The type of corner and location monuments used are as follows: 4" square white wooden post - 4 ft. in height
3. The bearings and distances in degrees and feet between claim corners are as depicted on the map.

Form MCF100a
Revised July 2005

This form is available from the Arizona Department of Mines & Mineral Resources and may be reproduced.

AMC425568

AMC 425567

Return To:
SEE BELOW

AMENDMENT AMC 425569

LOCATION NOTICE FOR LODE MINING CLAIM

NOTICE IS HEREBY GIVEN that the Silver Gate
lode mining claim has been located
by Richard W. CARTER / DIANA L. HANS whose current mailing

address is 19701 E. Squaw Valley Pkwy.
Black Canyon City, AZ. 85324

RECEIVED
BLM AZ STATE OFFICE
2014 JAN 16 P 3:06
PHOENIX, ARIZONA
BLM
Date
Stamp

The general course of this claim is SW TO NE and it is situated in YAVAPAI
County, Arizona. This claim is 1500 feet in length and 600 feet in width. This claim runs
from the location monument on which this location notice is posted approximately 600 feet in a
NW direction to the W end line and 1500 feet in a SW direction to the
S end line. This claim is marked by six monuments, one at each corner and one at the center of each
end line of the claim.

The location monument on which this notice is posted is situated within Section 7, Township 10
N, Range 02 E, Gila Salt River Base and Meridian, Arizona and this claim encompasses portions
of the following quarter section (s), section (s), Township (s) and Range (s) NE 1/4 SEC 36
T11N R01E E SW 1/4 SEC 7 T10N R02E
Gila Salt River Base and Meridian, Arizona. *AMENDMENT FILED TO CORRECT THE LLD, PB*

The locality of this claim with reference to some natural object or permanent monument and additional information
(if any) concerning its locality are as follows: 3000 ft. NE OF ENTRANCE
TO SILVER CORD MINE

DATED AND POSTED on the ground this 4 day of Dec, 2013
LOCATOR (s) RICHARD W. CARTER
DIANA L. HANS

Diana L. Hans Richard W. Carter

INTERESTED
MAR 20 2014
BY: PB

Form MCF100
Revised July 2005

RECORDERS MEMO: LEGIBILITY
QUESTIONABLE FOR GOOD REPRODUCTION

MINING CLAIM MAP

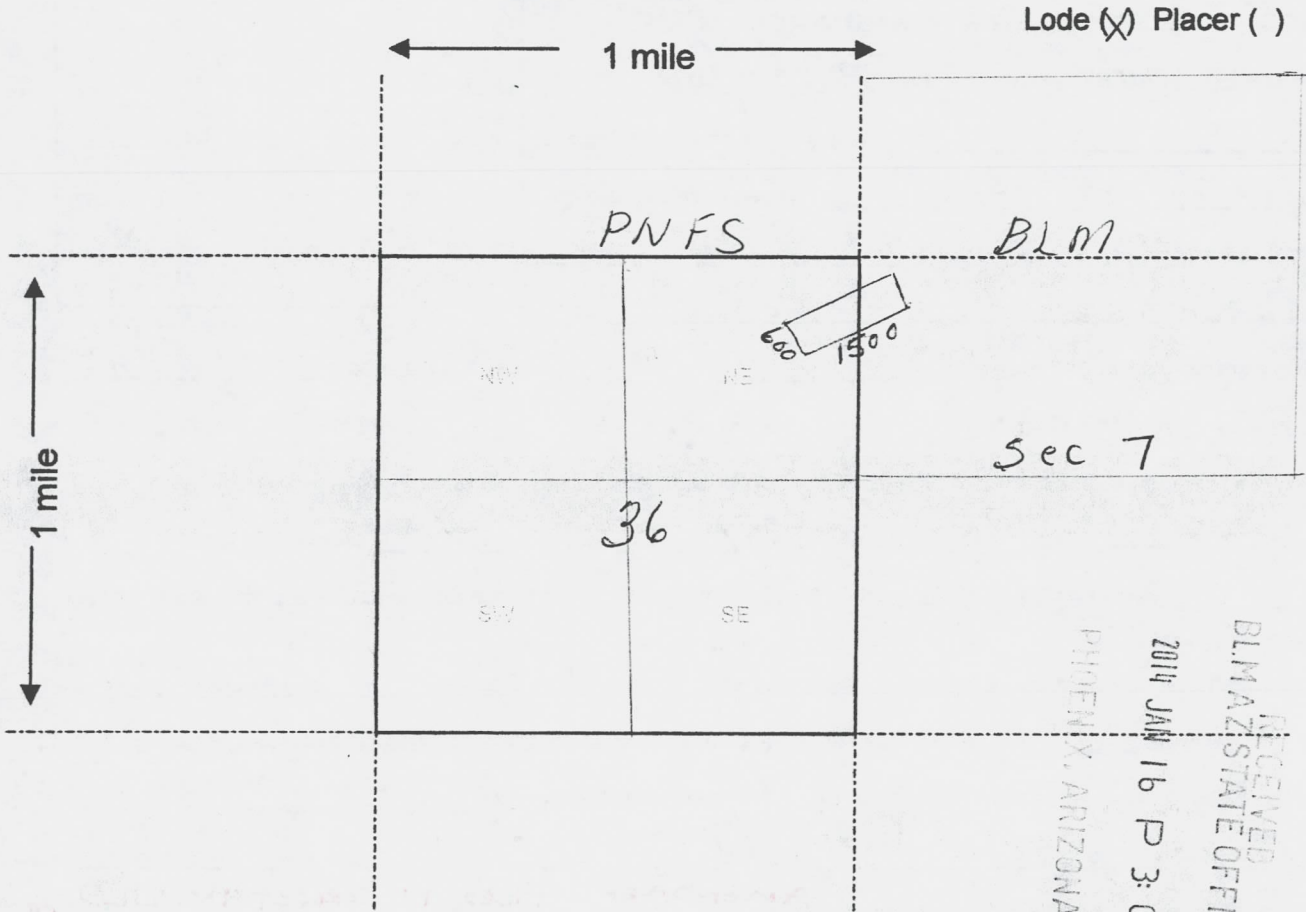

Scale : 1" = 2000 feet



1. The above map depicts the SILVER GATE mining claim, which is located in Section (s) 36 7, Township 11N 10N, Range 01 E 02 E, Gila and Salt River Base and Meridian, _____ County, Arizona.

2. The type of corner and location monuments used are as follows: 4" sq. white
wooden Post - 4 ft. in height

3. The bearings and distances in degrees and feet between claim corners are as depicted on the map.

Form MCF100a
Revised July 2005

This form is available from the Arizona Department of Mines & Mineral Resources and may be reproduced.

LOCATION NOTICE FOR LODE MINING CLAIM

NOTICE IS HEREBY GIVEN that the SILVER GATE lode mining claim has been located

by Richard W. Carter / DIANA L. HANS whose current mailing address is 19701 E. SQUAW VALLEY PKWY. BLACK CANYON CITY, AZ 85324

BLM Date Stamp
PHOENIX, ARIZONA
2013 DEC - 5 P 1:52
RECEIVED
BLM AZ STATE OFFICE

The general course of this claim is SW TO NE and it is situated in YAVAPAI County, Arizona. This claim is 1500 feet in length and 600 feet in width. This claim runs from the location monument on which this location notice is posted approximately 600 feet in a NW direction to the W end line and 1500 feet in a SW direction to the S end line. This claim is marked by six monuments, one at each corner and one at the center of each end line of the claim.

The location monument on which this notice is posted is situated within Section 7, Township 11 N, Range 02 E, Gila Salt River Base and Meridian, Arizona and this claim encompasses portions of the following quarter section (s), section (s), Township (s) and Range (s) NE 1/4 Sec 36 T11N R02E & NW 1/4 SEC 7 T11N R02E Gila Salt River Base and Meridian, Arizona.

depicted in the SW 1/4 of section 7 T11N R 2E

The locality of this claim with reference to some natural object or permanent monument and additional information (if any) concerning its locality are as follows: 3000 FT. NE OF ENTRANCE TO SILVER CORD MINE

DATED AND POSTED on the ground this 4 day of Dec, 2013

LOCATOR (s) RICHARD W. CARTER
DIANA L. HANS
Richard W. Carter Diana L. Hans

INTERESTED
DEC 12, 2013

BY: *in*
Form MCF100
Revised July 2005

This form is available from the Arizona Department of Mines & Mineral Resources and may be reproduced.

AN AMENDMENT WAS REC'D ON Jan 16, 2014 (R# 2951504) Amendment PROCESSED ON 3/20/2014 to correct the L&D. P.B. Brown

AMC425569

MINING CLAIM MAP

Lode (X) Placer ()

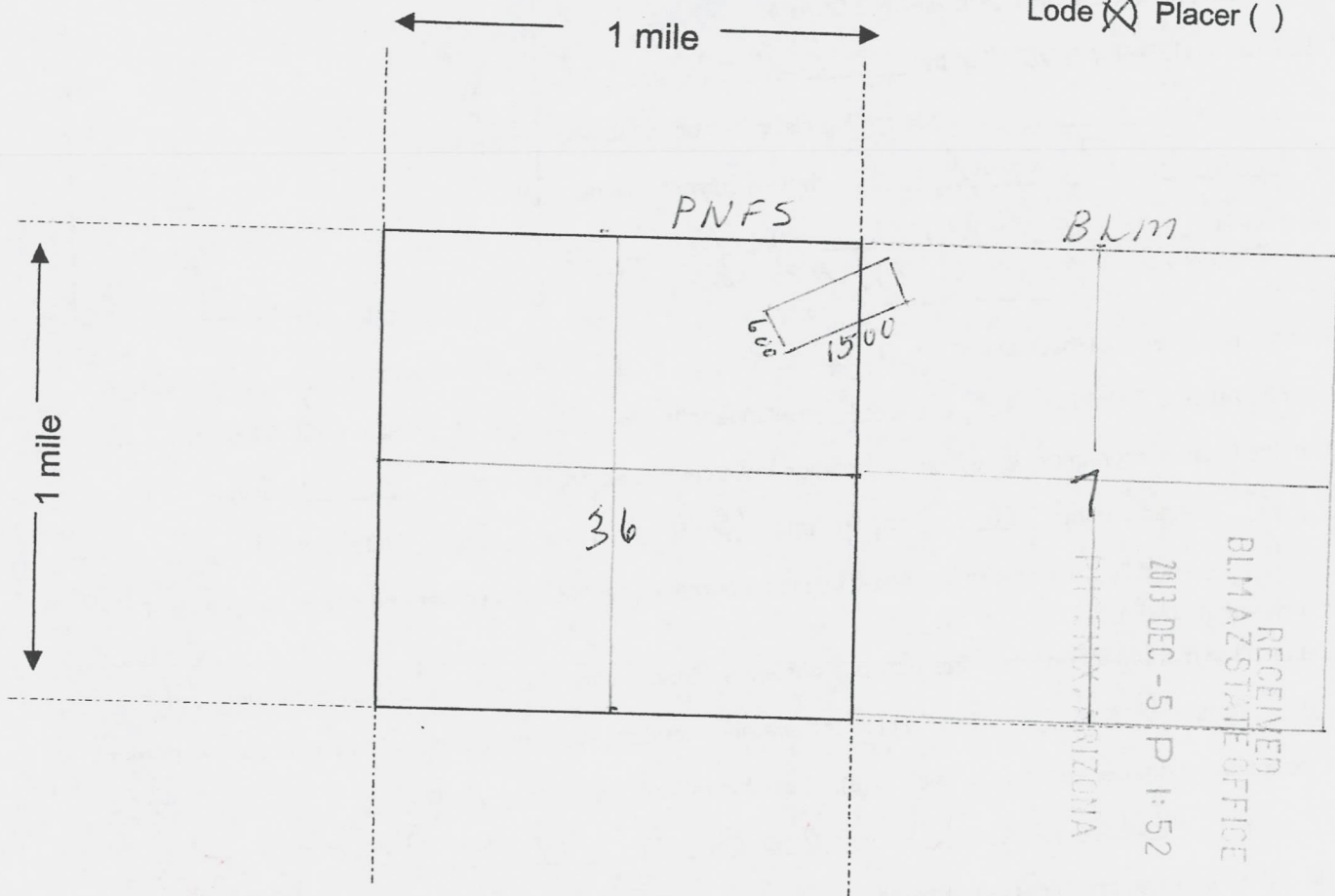

Scale : 1" = 2000 feet



1. The above map depicts the SILVER GATE mining claim, which is located in Section (s) 36, Township 11N, Range 01 E, Gila and Salt River Base and Meridian, 7 County, Arizona.

2. The type of corner and location monuments used are as follows: 4" sq. white WOODEN POST - 4 ft in height.

3. The bearings and distances in degrees and feet between claim corners are as depicted on the map.

Form MCF100a
Revised July 2005

This form is available from the Arizona Department of Mines & Mineral Resources and may be reproduced.

AN0425569

TOWNSHIP 10 NORTH RANGE 02 EAST OF THE GILA & SALT RIVER MERIDIAN, ARIZONA

SECS	SUBDIVISION																Acres	Kind of Entry or Purpose	Serial Number or Order Number	Action Date	Remarks		
	NE 1/4				NW 1/4				SW 1/4				SE 1/4									Lots	Other Description
	NE	NW	SW	SE	NE	NW	SW	SE	NE	NW	SW	SE	NE	NW	SW	SE							
For orders affecting disposal or use of unidentified lands withdrawn for classification, minerals, water, and/or other public purposes, and Indian treaties, refer to Index to Miscellaneous Documents																							
25																		MS 1286;					
36																		MS 1286;	PATENT / ME	31648	11/3/1899	MC 359;	
36																	178.947	MS 1470;	PATENT / ME	34505	10/17/1901	MC 422; 9 1/2N 2E;	
	ENTIRE TOWNSHIP																				12/14/1901	CHANGED TO RIO VERDE NF ACT 3/4/1907; SO REST 5/16/1910; 13N 1E;	
6																	20.661	MS 1913;	PATENT / ME	41884	10/20/1906	CADASTRAL SURVEY SHOWS LOCATED IN 11N 2E;	
																	146.695	MS 2138;	PATENT / ME	44530	10/20/1906	MC 150; 11N 1E;	
	ENTIRE TOWNSHIP																				5/16/1910	OPEN TO ENTRY; 13N 1E;	
																		ALL SECS 2, 16, 32, 36;	STATE GRANT	ACT OF CONGRESS	6/20/1910	TITLE TO STATE TO FIX ON APPROVAL OF SURVEY; SUBJECT TO PRIOR RIGHTS;	
33			X														40.00	HE	PHX-022166	6/9/1913	CANC 8/5/1920;		
33								X									40.00	9 1/2N 2E;	PATENT / HE	380377	1/26/1914	(PHX-022168);	
33									X	X	X	X					120.00	PATENT / HE	426411	8/20/1914	(PHX-022167);		
	ENTIRE TOWNSHIP																	12N 2E;	EO TEMP WDL STOCK DRIVEWAY	2465-A	9/30/1916	REV EO 3037, 2/25/1919;	
1																		ALL;					
2																		ALL;					
3																		ALL;					
4																		ALL;					
5	X	X	X	X						X	X	X	X										
8																		ALL;					
9																		ALL;					
10																		ALL;					
11																		ALL;					
14																		ALL;					
15	X	X	X	X	X	X	X	X															
16	X	X	X	X	X	X	X	X	X	X													
17																		ALL;					
18	X	X	X	X						X	X	X	X										
19	X	X	X	X						X	X	X	X										

TOWNSHIP 10 NORTH RANGE 02 EAST OF THE GILA & SALT RIVER MERIDIAN, ARIZONA

SECS	SUBDIVISION																Acres	Kind of Entry or Purpose	Serial Number or Order Number	Action Date	Remarks		
	NE 1/4				NW 1/4				SW 1/4				SE 1/4									Lots	Other Description
	NE	NW	SW	SE	NE	NW	SW	SE	NE	NW	SW	SE	NE	NW	SW	SE							
For orders affecting disposal or use of unidentified lands withdrawn for classification, minerals, water, and/or other public purposes, and Indian treaties, refer to Index to Miscellaneous Documents																							
20																		ALL;					
21					X	X			X	X													
23																		ALL;					
26																		ALL;					
28					X	X			X	X													
29																		ALL;					
30	X	X	X	X									X	X	X	X							
31	X	X	X	X									X	X	X	X							
32																		ALL;					
33					X	X			X	X													
35																		ALL; 16N 1E;	SO WDL STOCK DRIVEWAY	56 (AR-2)	2/4/1919	SO PART REV 3/22/1926, 8/19/1941; REV PLO 6330, 9/1/1982; OPEN TO ENTRY 10/7/1982;	
	ENTIRE TOWNSHIP																	REV STOCK DRIVEWAY, EO 2465A, 9/30/1916	3037	2/25/1919	7N 2E;		
30																							
31																	77.342	PATENT / ME	911367	7/9/1923	(PHX-047680);		
36																		ALL; 9 1/2N 2E;	EO TEMP WDL FOR CL	4308	9/23/1925	O ADJ 3/22/1926;	
8									X	X									SO REV STOCK DRIVEWAY 56 (AR-2), SO 2/4/1919;		3/22/1926		
36	X																1-12		O ADJUSTMENT FOR CL, EO 4308, 9/23/1925		3/22/1926	REV O 3/2/1940;	
																		ALL SECS 2, 16, 32, 36;	STATE GRANT	ACT OF CONGRESS	1/25/1927	EXTENDS ACT OF 6/20/1910 TO MINERAL LANDS; SUBJECT TO PRIOR RIGHTS;	
34																	640.00	SRHE	PHX-061231	1/28/1928	REL 5/31/1932;		
24									X	X	X	X											
25	X	X			X	X	X	X	X	X							1, 2, 4, 5		SRHE	PHX-061641	1/28/1928	REL 7/23/1928;	
24									X	X	X	X											
25	X	X			X	X	X	X	X	X							1, 2, 4, 5		SRHE	PHX-063590	7/23/1928	REL 4/15/1930;	
33	X	X	X	X	X				X	X			X	X				9 1/2N 2E;	320.00 PATENT / SRHE	1031935	11/9/1929	(PHX-046989);	
25					X	X	X	X	X	X							4, 5	10N 5W;	315.69 SS MINER'S HOSPITALS	4	4/13/1931		
5																		M&B;					
8																		M&B;					

TOWNSHIP 10 NORTH RANGE 02 EAST OF THE GILA & SALT RIVER MERIDIAN, ARIZONA

SECS	SUBDIVISION																Acres	Kind of Entry or Purpose	Serial Number or Order Number	Action Date	Remarks				
	NE 1/4				NW 1/4				SW 1/4				SE 1/4									Lots	Other Description		
	NE	NW	SW	SE	NE	NW	SW	SE	NE	NW	SW	SE	NE	NW	SW	SE									
For orders affecting disposal or use of unidentified lands withdrawn for classification, minerals, water, and/or other public purposes, and Indian treaties, refer to Index to Miscellaneous Documents																									
17																				M&B;					
20																				M&B;					
28																				M&B;					
29																				M&B;					
32																				M&B;					
33																				M&B; SUBDIVUNDEF;	R/W TELEPHONE AND TELEGRAPH LINE	PHX-068718	6/10/1931	TERM 6/10/1981; 14N 1W;	
32																				ALL;	640.00	L BASE	111	4/27/1932	3S 14E;
2			X	X			X	X	X	X	X	X	X	X	X	X	X	1-3, PART 4	9S 14E;	634.30	L BASE	112	7/16/1932		
16											X								25N 1E;	40.00	L BASE	114	10/20/1932		
24						X	X														80.00	SRHE	PHX-073503	1/10/1934	CANC 10/17/1939;
6																		8, 9							
7	X	X	X	X	X													1, 2							
8						X	X	X					X	X		X									
9											X														
15											X														
16			X	X	X	X	X	X																	
22			X	X	X	X	X						X	X		X									
23											X														
26						X	X	X	X	X			X	X	X	X									
35	X																								
36																	3, 4	ALL LANDS LYING WITHIN 25 FT OF CENTER LINE OF TRANSMISSION LINE;		O WDL PWR PROJECT	AR-1167	7/3/1935	10N 1E; ENLGMT 8/14/1936; TERM 12/31/1950; (AR-0109);		
16	X	X	X	X	X	X	X	X		X									14S 27E;	360.00	L BASE	145	8/28/1935		
6							X	X				X					3								
7					X														ALL LANDS LYING WITHIN 25 FT OF CENTER LINE OF TRANSMISSION LINE;		O WDL PWR PROJECT	AR-447	9/10/1935	11 1/2N 1E; TERM 12/31/1950;	
34	X	X	X	X	X	X	X	X	X				X	X	X	X				560.00	PATENT / SRHE	1082896	5/4/1936	(PHOENIX-072363);	
6																	8, 9								
7	X	X	X	X	X												1-4, 6								

TOWNSHIP 10 NORTH RANGE 02 EAST OF THE GILA & SALT RIVER MERIDIAN, ARIZONA

SECS	SUBDIVISION																Acres	Kind of Entry or Purpose	Serial Number or Order Number	Action Date	Remarks		
	NE 1/4				NW 1/4				SW 1/4				SE 1/4									Lots	Other Description
	NE	NW	SW	SE	NE	NW	SW	SE	NE	NW	SW	SE	NE	NW	SW	SE							
For orders affecting disposal or use of unidentified lands withdrawn for classification, minerals, water, and/or other public purposes, and Indian treaties, refer to Index to Miscellaneous Documents																							
8							X	X	X					X	X	X							
9													X										
15													X										
16			X		X	X	X	X															
22			X		X	X	X	X					X	X	X								
23												X											
26					X	X	X	X	X	X				X	X	X							
35	X																						
36																3, 4	ALL LANDS LYING WITHIN 25 FT OF CENTER LINE OF TRANSMISSION LINE;	O ENLGMT PWR PROJECT AR-1167, O 7/3/1935	8/14/1936	10N 1E; TERM 12/31/1950;			
27																	ALL;	640.00 PATENT / SRHE	1085371	8/21/1936 (PHX-061929);			
																	PART DEFICIT;	1.40 ML BASE	155	12/29/1936 14S 11E;			
22																	ALL;	640.00 PATENT / SRHE	1096980	5/11/1938 (PHX-070837);			
28	X	X	X	X	X			X	X	X	X	X	X	X	X	X			480.00 PATENT / SRHE	1099067	9/27/1938 (PHX-071636);		
34									X	X								80.00 PATENT / SRHE	1099167	10/17/1938 (PHX-072362);			
36		X														1-12		O REV FOR CL O 3/22/1926	4308	3/2/1940			
12																	ALL;	580.28					
13																	ALL;	605.39					
24		X	X		X			X	X	X	X	X	X	X		1-4			539.12				
25		X	X										X	X		1-3, 6	9N 2E;	307.00 PATENT / SX	1109491	10/28/1940 (PHX-075462);			
5	X	X	X	X									X	X	X	X			316.30				
8	X	X	X	X	X	X	X	X	X					X	X	X	X	X		560.00			
16									X	X								80.00					
21					X	X			X	X								160.00					
28					X	X			X	X								160.00					
33					X	X			X	X								160.00					
35	X	X	X	X									X	X	X	X	11N 2E;	320.00 REV STOCK DRIVEWAY 56 (AR-2), SO 2/4/1919		8/19/1941			
33																	M&B;	R/W TRANSMISSION LINE	PHX-080374	4/2/1942 TO TERM 4/1/1992; PROOF OF CONSTRUCTION ACCEPTED; CASE CLOSED 10/14/1993;			

TOWNSHIP 10 NORTH RANGE 02 EAST OF THE GILA & SALT RIVER MERIDIAN, ARIZONA

SECS	SUBDIVISION																Acres	Kind of Entry or Purpose	Serial Number or Order Number	Action Date	Remarks		
	NE 1/4				NW 1/4				SW 1/4				SE 1/4									Lots	Other Description
	NE	NW	SW	SE	NE	NW	SW	SE	NE	NW	SW	SE	NE	NW	SW	SE							
For orders affecting disposal or use of unidentified lands withdrawn for classification, minerals, water, and/or other public purposes, and Indian treaties, refer to Index to Miscellaneous Documents																							
26																		M&B; SUBDIV UNDEF;	R/W TRANSMISSION LINE	PHX-081354	8/8/1945	PERPETUAL; 11N 2E; APPVD FOR PD ONLY;	
23	X	X	X	X									X	X	X	X		E2E2W2;	R/W HIGHWAY	PHX-084089	3/11/1949	PERPETUAL; PROOF OF CONSTRUCTION 12/17/1963;	
26	X	X	X	X									X	X	X	X			R/W HIGHWAY	PHX-084090	3/11/1949	PERPETUAL; PROOF OF CONSTRUCTION 12/17/1963;	
35	X				X	X	X	X	X										R/W HIGHWAY	PHX-084091	3/17/1949	PERPETUAL; PROOF OF CONSTRUCTION 12/17/1963;	
24					X	X												8N 4E;	80.00 PATENT / SX	1125545	4/25/1949	(PHX-080325);	
23																		W2NWSWSE, E2NESESW;	R/W MATERIAL SITE	PHX-084587	7/22/1949	REL 12/3/1964;	
2	X	X			X				X				X	X					R/W HIGHWAY	PHX-084086	2/14/1950	PERPETUAL; PROOF OF CONSTRUCTION 1/7/1964;	
11	X	X											X	X				E2E2W2;	R/W HIGHWAY	PHX-084087	2/14/1950	PERPETUAL; PROOF OF CONSTRUCTION 12/17/1963;	
14	X	X	X	X									X	X	X	X			R/W HIGHWAY	PHX-084088	2/14/1950	PERPETUAL; PROOF OF CONSTRUCTION 12/17/1963;	
2																		M&B;					
11																		M&B;					
14																		M&B;					
23																		M&B;					
26																		M&B;					
35																		M&B; SUBDIV UNDEF;	R/W TRANSMISSION LINE	PHX-085401	3/2/1950	PERPETUAL; 14N 2W; PROOF OF CONSTRUCTION 6/17/1952;	
35	X	X	X	X									X	X	X	X		9N 2E;	320.00 PATENT / SX	1129316	6/20/1950	(PHX-080231);	
19					X				X								1-4		215.59 PATENT / SX	1129478	7/20/1950	(PHX-080459); OTHER TPS: 12N 3W, 16S 8E, 16S 9E, 16S 10E, 17S 10E;	
6																		M&B;					
7																		M&B;					
8																		M&B;					
9																		M&B;					
15																		M&B;					
16																		M&B;					
22																		M&B;					
23																		M&B;					
26																		M&B;					
27																		M&B;					
28																		M&B;					
33																		M&B; SUBDIV UNDEF;	R/W TRANSMISSION LINE	AR-0109	1/1/1951	12N 1E; PROOF OF CONSTRUCTION ACCEPTED; APPVD FOR PD ONLY; PART REL 5/8/1970; EXPIRED 12/31/2000; CASE CLOSED 8/21/2001;	

TOWNSHIP 10 NORTH RANGE 02 EAST OF THE GILA & SALT RIVER MERIDIAN, ARIZONA

SECS	SUBDIVISION																Acres	Kind of Entry or Purpose	Serial Number or Order Number	Action Date	Remarks			
	NE 1/4				NW 1/4				SW 1/4				SE 1/4									Lots	Other Description	
	NE	NW	SW	SE	NE	NW	SW	SE	NE	NW	SW	SE	NE	NW	SW	SE								
For orders affecting disposal or use of unidentified lands withdrawn for classification, minerals, water, and/or other public purposes, and Indian treaties, refer to index to Miscellaneous Documents																								
11	X			X														80.00	SLUP HAUL ROAD	AR-031247	4/18/1962	EXPIRED 4/17/1967;		
1			X	X			X	X	X															
2																			PART S2SENE, N2NESE;	SLUP HAUL ROAD	AR-031248	4/25/1962	EXPIRED 4/24/1967; 11N 3E;	
2																	PART 1, 2		NWNESENE, NWISENE, NENESWNE;	FLUP #210	AR-031246	5/7/1962	EXPIRED 6/1/1967;	
16									X				X	X	X	X		240.00	PATENT / SS	02-64-0100	1/17/1964	(AR-032695);		
36	X																1-12	472.13	PATENT / SS	02-64-0154	2/28/1964	(AR-032696B);		
26													X	X	X	X								
35					X	X	X	X	X	X	X	X							RAW HIGHWAY	AR-032230	3/13/1964	PERPETUAL; OTHER TPS: 9N 2E, 9 1/2N 2E; AMENDED 7/24/1964;		
23																			RI RAINWATER CATCHMENT	A-4337	9/3/1968			
1			X			X	X	X	X	X	X	X		X	X		1-7							
2			X	X		X	X	X	X	X	X	X		X	X	X	1-4							
3			X	X		X	X	X	X	X	X	X		X	X	X	1-4							
4			X	X		X	X	X	X	X	X	X		X	X	X	1-4							
9																			ALL;					
10																			ALL;					
11																			ALL;					
14																			ALL;					
15	X	X	X	X	X	X	X	X																
16	X	X	X	X	X	X	X	X																
17																			ALL;					
18	X	X	X	X									X	X	X	X								
19	X	X	X	X									X	X	X	X								
20																			ALL;					
23																			ALL;					
26																			ALL;					
29																			ALL;					
30	X	X	X	X									X			X	5, 11							
31	X			X									X	X	X	X	1, 6							
32																			ALL;					

TOWNSHIP 10 NORTH RANGE 02 EAST OF THE GILA & SALT RIVER MERIDIAN, ARIZONA

SECS	SUBDIVISION																Acres	Kind of Entry or Purpose	Serial Number or Order Number	Action Date	Remarks		
	NE 1/4				NW 1/4				SW 1/4				SE 1/4									Lots	Other Description
	NE	NW	SW	SE	NE	NW	SW	SE	NE	NW	SW	SE	NE	NW	SW	SE							
For orders affecting disposal or use of unidentified lands withdrawn for classification, minerals, water, and/or other public purposes, and Indian treaties, refer to Index to Miscellaneous Documents																							
35					X	X	X	X	X	X	X	X						6N 2E;	SO DES BLACK CANYON TRAILS AREA	A-2936	1/3/1969	PUB IN FR 1/10/1969;	
14												X						W2SESW;	60.00				
23					X	X			X	X								W2E2W2;	240.00				
26					X	X	X	X	X	X	X	X						PROPOSED CL / EXCHANGE	280.00	A-454-A	5/13/1969	LAKE MEAD;	
14												X						W2SESW;					
23					X	X			X	X								W2E2W2;					
26					X	X	X	X	X	X	X	X						APLN / PX		A-454-A	9/15/1969	LAKE MEAD; PATENT 02-70-0075, 4/15/1970;	
14												X						W2SESW;					
23					X	X			X	X								W2E2W2;					
26					X	X	X	X	X	X	X	X						PATENT / PX	580.00	02-70-0075	4/15/1970	(A-454-A);	
2		X															2	11N 2E;		A-6011	5/21/1971	EXPIRED 5/20/1967;	
6																		M&B;					
7																		M&B;					
2																		PART 2, 3 LYING BETWEEN I-17 R/W AND BLOODY BASIN RD	9.00	APLN / IL	A-17000-X	8/27/1981	SEGREGATED FROM THE PUBLIC LAND LAWS, INCLUDING THE MINING LAWS, BUT NOT THE MINERAL LEASING LAWS; SEG TO TERM REMAINING PUBLIC LAND 8/27/1983;
17	X	X	X	X									X	X	X	X							
20	X	X	X	X									X	X	X	X							
28									X	X													
29	X	X	X	X									X	X	X	X							
32	X			X									X			X							
33					X	X												12N 1E;		A-13912	7/14/1982	EFF 6/10/1981; TO TERM 6/10/2011; PART REL 9/3/1993;	
1		X			X	X	X	X	X	X	X	X	X	X			1-7						
2		X	X		X	X	X	X	X	X	X	X	X	X	X	X	1-4						
3		X	X		X	X	X	X	X	X	X	X	X	X	X	X	1-4						
4		X	X		X	X	X	X	X	X	X	X	X	X	X	X	1-4						
9																		ALL;					
10																		ALL;					
11																		ALL;					

TOWNSHIP 10 NORTH RANGE 02 EAST OF THE GILA & SALT RIVER MERIDIAN, ARIZONA

SECS	SUBDIVISION																Acres	Kind of Entry or Purpose	Serial Number or Order Number	Action Date	Remarks		
	NE 1/4				NW 1/4				SW 1/4				SE 1/4									Lots	Other Description
	NE	NW	SW	SE	NE	NW	SW	SE	NE	NW	SW	SE	NE	NW	SW	SE							
For orders affecting disposal or use of unidentified lands withdrawn for classification, minerals, water, and/or other public purposes, and Indian treaties, refer to index to Miscellaneous Documents																							
14																		ALL;					
15	X	X	X	X	X	X	X	X															
16	X	X	X	X	X	X	X	X															
17																		ALL;					
18	X	X	X	X									X	X	X	X							
19	X	X	X	X									X	X	X	X							
20																		ALL;					
23																		ALL;					
26																		ALL;					
29																		ALL;					
30	X	X	X	X									X	X	X	X							
31	X	X	X	X									X	X	X	X							
32																		ALL;					
35					X	X	X	X	X	X	X	X						6N 2E;	PLO REV STOCK DRIVEWAY 56 (AR-2), SO 2/4/1919	6330	9/1/1982	(A-13382); OPEN TO ENTRY 10/7/1982;	
2													2					R/W ROAD	A-18024	6/29/1983	TO TERM 6/28/2013;		
17																		PART;					
21																		PART;					
28																		PART;					
33																		PART;	R/W ROAD	A-19323	8/3/1984	PERPETUAL; RS 2477; LD TP: 9N 2E; AMENDED 4/29/1992;	
1																		PART;					
2																		PART;	16.00 R/W ROAD	A-19326	8/3/1984	PERPETUAL; RS 2477; OTHER TPS: 11N 2E, 10N 3E;	
1			X			X	X	X	X	X	X	X		X	X		1-7						
2			X	X		X	X	X	X	X	X	X	X	X	X	X	1-4						
3			X	X		X	X	X	X	X	X	X	X	X	X	X	1-4						
4			X	X		X	X	X	X	X	X	X	X	X	X	X	1-4						
9																		ALL;					
10																		ALL;					
11																		ALL;					
14	X	X	X	X	X	X	X	X	X	X	X	X		X	X	X		E2SESW;					

TOWNSHIP 10 NORTH RANGE 02 EAST OF THE GILA & SALT RIVER MERIDIAN, ARIZONA

SECS	SUBDIVISION																Acres	Kind of Entry or Purpose	Serial Number or Order Number	Action Date	Remarks		
	NE 1/4				NW 1/4				SW 1/4				SE 1/4									Lots	Other Description
	NE	NW	SW	SE	NE	NW	SW	SE	NE	NW	SW	SE	NE	NW	SW	SE							
For orders affecting disposal or use of unidentified lands withdrawn for classification, minerals, water, and/or other public purposes, and Indian treaties, refer to Index to Miscellaneous Documents																							
15	X	X	X	X	X	X	X	X															
16	X	X	X	X	X	X	X	X															
17	X	X	X	X									X	X	X	X							
23	X	X	X	X									X	X	X	X	E2E2W2;						
26	X	X	X	X					X	X	X	X	X	X	X	X							
33					X	X			X														
35					X	X	X	X	X	X	X	X						NORA / SX	A-20346-B	3/27/1985	SEGREGATED FROM THE PUBLIC LAND LAWS AND THE MINING LAWS; OPEN TO THE MINERAL LEASING LAWS AND GEOTHERMAL STEAM ACT; SEG TO TERM 3/26/1987; SEG EXT 3/27/1987; TO TERM 3/26/1989;		
1			X		X	X											2						
2		X	X										X	X				R/W ROAD	A-22083	6/24/1986	TO TERM 12/31/1988; EXPIRED AND CASE CLOSED 1/18/1989;		
4																	PART 4	E2E2SWNW, SWSWSE, W2W2NESW, E2E2SWSW, SWSESW, NWNWSESW;					
9																		W2E2NWNW, E2W2NWNW, E2NWSWNW, SWNWSWNW, W2SWSWNW, W2W2W2SW;					
16																		W2W2NWNW, W2NWSWNW, NWSWSWNW;					
17																		SWNWNW, NWSWNE, N2S2S2NE, SENENW, E2SEENW, N2N2N2SW;					
18																		NESWNE, SESWSWNE, W2SESWNE, W2NWSENE, SENWSENE, NESWSENE, W2SESENE, SESESENE, S2NESESESW, SENWSESESW, SENWSESESW, E2SWSESESW, SESESESW, E2W2E2SESW, E2E2SESW, NENENESE, E2NWNWSE, NESWNWSE, S2NWSWNWSE, N2S2S2NWSWSE;					
19																		E2E2NENW, E2W2E2NENW, E2E2SEENW, E2W2NESEENW, NENENESE, E2E2SESW, W2W2NWNWSE, NWNWSWSE, W2SWNWSWSE, W2NWSWSWSE, SWSWSWSE;					

TOWNSHIP 10 NORTH RANGE 02 EAST OF THE GILA & SALT RIVER MERIDIAN, ARIZONA

SECS	SUBDIVISION																Acres	Kind of Entry or Purpose	Serial Number or Order Number	Action Date	Remarks		
	NE 1/4				NW 1/4				SW 1/4				SE 1/4									Lots	Other Description
	NE	NW	SW	SE	NE	NW	SW	SE	NE	NW	SW	SE	NE	NW	SW	SE							
For orders affecting disposal or use of unidentified lands withdrawn for classification, minerals, water, and/or other public purposes, and Indian treaties, refer to Index to Miscellaneous Documents																							
30																		N2NWNWNE, SENWNWNE, E2SWNWNE, SWSENWNE, W2NESWNE, SENESWNE, E2SESWNE, SWNWSENE, W2SWSENE, NWNWESE, N2SWNESE, SWSWNESE, E2NENWSE, S2SENWSE, W2E2SWSE;					
31														PART 1, 6-9;	W2SENE; SWNESW, E2W2SESW, W2SESESW, E2E2NWSE, E2NESWSE, W2NWSWSE, SENWSESE, N2SWSESE, SESWSESE;		MANAGEMENT AGREEMENT DES BLACK CANYON HIKING EQUESTRIAN TRAIL	AZA-22689	5/14/1987	TO TERM 5/13/2012; LD TP: 8N 2E;			
17			X				X								X	X	X	X					
20	X																	LD TP: 12N 1E;	R/W BURIED COMMUNICATION LINE	AZA-22632	7/16/1987	TO TERM 7/15/2017; AMENDED 1/6/1989;	
5			X	X			X	X	X	X	X	X	X	X	X	X	X	1-4					
6			X	X			X	X		X	X	X	X	X	X	X	X	1-9					
7	X	X	X	X	X		X	X		X	X	X	X	X	X	X	X	1-8					
8	X	X	X	X						X	X	X	X	X	X	X							
18				X			X	X		X								1-8					
19				X			X	X		X								1-8					
30				X			X											1-4, 6-10					
31								X		X								3-5, 7-10	LD TP: 9N 1E;	DEED OF RECON / SX	AZA-22699	4/4/1988	
5																		PART NENE;					
7																		PART NENW;	SLUP	AZA-23340	5/31/1988	TO TERM 1/15/1993; CLOSED 4/6/1994;	
6																		PART 4, 5, 7	PART W2SENW;	R/W PUBLIC ROADWAY	AZA-23341	5/31/1988	STATE ISSUED 10/22/1987; PERPETUAL; REL AND CASE CLOSED 8/3/2009
8				X	X	X	X	X	X	X	X	X											
14										X									W2SESW;				
16										X	X												
21	X	X	X	X																			
22																			ALL;				
23						X	X			X	X								W2E2W2;				
26				X	X	X	X	X	X	X	X												
27																			ALL EXCEPT M&B;				

TOWNSHIP 10 NORTH RANGE 02 EAST OF THE GILA & SALT RIVER MERIDIAN, ARIZONA

SECS	SUBDIVISION																Acres	Kind of Entry or Purpose	Serial Number or Order Number	Action Date	Remarks		
	NE 1/4				NW 1/4				SW 1/4				SE 1/4									Lots	Other Description
	NE	NW	SW	SE	NE	NW	SW	SE	NE	NW	SW	SE	NE	NW	SW	SE							
For orders affecting disposal or use of unidentified lands withdrawn for classification, minerals, water, and/or other public purposes, and Indian treaties, refer to Index to Miscellaneous Documents																							
28																		E2, E2W2 EXCEPT M&B;					
33																		E2, E2W2 EXCEPT M&B;					
34																		ALL EXCEPT M&B;	WD RECON TO US	A-22792-B	12/16/1988	LD TP: 9N 1E;	
5			X						X				X				2						
17		X		X			X					X	X	X	X								
20	X																	LD TP: 12N 1E;	R/W TELEPHONE AND TELEGRAPH LINE AMENDED	AZA-22632	1/6/1989	TO TERM 7/15/2017;	
1			X			X	X	X	X	X	X	X	X	X			1-7						
2		X	X			X	X	X	X	X	X	X	X	X			1-4						
3		X	X			X	X	X	X	X	X	X	X	X			1-4						
4		X	X			X	X	X	X	X	X	X	X	X			1-4						
9																		ALL;					
10																		ALL;					
11																		ALL;					
14	X	X	X	X	X	X	X	X	X	X								E2SESW;					
15	X	X	X	X	X	X	X	X															
16	X	X	X	X	X	X	X	X															
17	X	X	X	X								X	X	X	X								
23	X	X	X	X								X	X	X	X			E2E2W2;					
26	X	X	X	X								X	X	X	X								
33						X	X			X													
35					X	X	X	X	X	X	X							LD TP: 1N 151/2E;	NORA	AZA-20346-U	3/22/1989	SEGREGATES THE LANDS FROM APPROPRIATION UNDER THE PUBLIC LAND LAWS AND THE MINING LAWS, BUT NOT THE MINERAL LEASING LAWS OR GEOTHERMAL STEAM ACT; SEG TO TERM 3/21/1991;	
5						X	X			X							3,4						
17		X		X			X					X	X	X	X								
20	X																		R/W COMMUNICATION SITE	AZA-23641	4/13/1989	TO TERM 4/12/2019;	
5				X	X	X	X	X	X	X	X												
6							X	X	X	X													
7	X	X	X	X	X	X	X	X				X	X	X	X								
8				X	X	X	X	X	X	X	X												

TOWNSHIP 10 NORTH RANGE 02 EAST OF THE GILA & SALT RIVER MERIDIAN, ARIZONA

SECS	SUBDIVISION																Acres	Kind of Entry or Purpose	Serial Number or Order Number	Action Date	Remarks						
	NE 1/4				NW 1/4				SW 1/4				SE 1/4									Lots	Other Description				
	NE	NW	SW	SE	NE	NW	SW	SE	NE	NW	SW	SE	NE	NW	SW	SE											
For orders affecting disposal or use of unidentified lands withdrawn for classification, minerals, water, and/or other public purposes, and Indian treaties, refer to Index to Miscellaneous Documents																											
20	X																		LD TP: 9N 2E;	R/W ROAD AMENDED	AZA-19323	4/29/1992	PERPETUAL;				
35		X																		R/W ROAD	AZA-27211	9/10/1992	STATE ISSUED 1/5/1963; PERPETUAL; LD TP: 9N 2E;				
35																				R/W ROAD	AZA-27212	9/10/1992	STATE ISSUED 8/20/1947; PERPETUAL;				
33											X									R/W UNDERGROUND COMMUNICATION LINE	AZA-27224	9/10/1992	STATE ISSUED 5/15/1987; TO TERM 5/14/2037;				
25																				W2W2NW;							
35	X	X	X	X												X			LD TP: 9N 2E;	R/W PIPELINE, ROAD AND POWERLINES	AZA-27234	9/10/1992	STATE ISSUED 1/12/1960; PERPETUAL;				
24																				W2W2NWNW;	AZA-27235	9/10/1992	STATE ISSUED 6/29/1961; PERPETUAL;				
16													X	X	X	X				R/W POWER LINE	AZA-27241	9/10/1992	STATE ISSUED 3/2/1959; PERPETUAL;				
2			X																2	11N 2E;				R/W MATERIAL SITE AND HAUL ROAD	AZA-27797	5/10/1993	TO TERM 5/9/2003; CASE CLOSED 5/28/2003;
6																			4, 5		0.976			R/W ROAD	AZA-26086	6/17/1993	TO TERM 6/16/2023;
2			X																2					R/W ROAD	AZA-29553	7/10/1996	PERPETUAL; OTHER TP: 11N 2E;
6																			4, 5, 7	W2SENW;		4.00		R/W ROAD	AZA-30476	11/10/1998	TO TERM 11/9/2028;
1			X				X	X	X	X	X	X			X	X			1-7								
2			X	X			X	X	X	X	X	X	X	X	X	X	X	X	1-4								
3			X	X			X	X	X	X	X	X	X	X	X	X	X	X	1-4								
4			X	X			X	X	X	X	X	X	X	X	X	X	X	X	1-4								
5			X	X			X	X	X	X	X	X	X	X	X	X	X	X	1-4								
6			X	X			X	X			X	X	X	X	X	X	X	X	1-9								
7	X	X	X	X	X			X	X			X	X	X	X	X	X	X	1-8								
8																				ALL;							
9																				ALL;							
10																				ALL;							
11																				ALL;							
12		X	X		X	X	X	X	X	X	X	X	X	X	X	X	X	X	1-4								
13		X	X		X	X	X	X	X	X	X	X	X	X	X	X	X	X	1-4								
14																				ALL;							
15																				ALL;							
16																				ALL;							

TOWNSHIP 10 NORTH RANGE 02 EAST OF THE GILA & SALT RIVER MERIDIAN, ARIZONA

SECS	SUBDIVISION																Acres	Kind of Entry or Purpose	Serial Number or Order Number	Action Date	Remarks		
	NE 1/4				NW 1/4				SW 1/4				SE 1/4									Lots	Other Description
	NE	NW	SW	SE	NE	NW	SW	SE	NE	NW	SW	SE	NE	NW	SW	SE							
For orders affecting disposal or use of unidentified lands withdrawn for classification, minerals, water, and/or other public purposes, and Indian treaties, refer to Index to Miscellaneous Documents																							
17																		ALL;					
18	X	X	X	X	X			X	X			X	X	X	X	X	1-8						
19	X	X	X	X	X			X	X			X	X	X	X	X	1-8						
20																		ALL;					
21																		ALL;					
22																		ALL;					
23																		ALL;					
24		X	X		X	X	X	X	X	X	X			X	X		1-4						
25		X	X		X	X	X	X	X					X	X		1-6						
26																		ALL;					
27	X	X	X	X			X	X	X	X	X	X	X	X	X	X		N2NW EXCL PATENT 1085371; FED MINS FOR PATENT 1085371;					
28	X	X	X	X	X	X	X	X	X	X	X			X	X			N2SE EXCL PATENT 1099067; FED MINS FOR PATENT 1099067;					
29																		ALL;					
30	X	X	X	X	X			X						X		X	1-11	MS 3748, MS 3749, MS 3750, MS 3845 EXCL PATENT 911367;					
31	X			X				X				X	X	X	X	X	1-10	MS 3748, MS 3750;					
32																		ALL;					
33		X	X			X	X			X	X							E2NE EXCL PATENT 1031935; E2W2 EXCL PATENTS 1031935, 380377 AND SE EXCL PATENTS 1031935, 426411; FED MINS FOR PATENT 1031935;					
34	X	X	X	X	X	X	X	X	X	X	X			X				E2SE EXCL PATENT 1082896; SWSE EXCL PATENT 1082896; FED MINS FOR PATENT 1082896;					
35																		ALL;					

TOWNSHIP 10 NORTH RANGE 02 EAST OF THE GILA & SALT RIVER MERIDIAN, ARIZONA

SECS	SUBDIVISION																Acres	Kind of Entry or Purpose	Serial Number or Order Number	Action Date	Remarks		
	NE 1/4				NW 1/4				SW 1/4				SE 1/4									Lots	Other Description
	NE	NW	SW	SE	NE	NW	SW	SE	NE	NW	SW	SE	NE	NW	SW	SE							
For orders affecting disposal or use of unidentified lands withdrawn for classification, minerals, water, and/or other public purposes, and Indian treaties, refer to Index to Miscellaneous Documents																							
36	X																1-12	LD TP: 9N 2E;		WDL / PROPOSED	AZA-31024	8/6/1999	PERRY MESA; SEGREGATES THE LANDS FROM LOCATION AND ENTRY UNDER THE GENERAL LAND LAWS, INCLUDING THE MINING LAWS, BUT NOT THE MINERAL LEASING LAWS; SEG TO TERM 8/5/2001; PUB IN FR 2/15/2001; SEG TERM AND LANDS NOT LOCATED WITHIN THE AGUA FRIA NMON ARE OPEN TO ENTRY AT 9:00 AM ON 3/19/2001;
1		X						X	X	X	X	X	X				1-7						
2																		M&B EAST OF HWY;					
11																		M&B EAST OF HWY;					
12	X	X			X	X	X	X	X	X	X	X	X				1-4						
13	X	X			X	X	X	X	X	X	X	X	X				1-4						
14																		M&B EAST OF HWY;					
23																		M&B EAST OF HWY;					
24	X	X			X	X	X	X	X	X	X	X	X				1-4						
25	X	X			X	X	X	X	X	X							1-6	MS 1286;					
26																		M&B EAST OF HWY;					
34																		M&B EAST OF HWY;					
35																		M&B EAST OF HWY;					
36	X																1-12	MS 1286;		PROC WDL AGUA FRIA NATIONAL MONUMENT	7283	1/11/2000	WDN FROM THE PUBLIC LAND LAWS AND THE MINING LAWS, INCLUDING THE MINERAL LEASING LAWS; (AZA-31024); LD TP: 11N 3E;
5						X		X	X	X	X						4						
8	X	X											X	X		X							
9												X											
16					X	X	X	X	X					X	X	X							
21	X			X																			
22					X	X			X	X													
27					X	X			X	X													
33																		UNPATENTED LAND IN SE, NE EXCL PATENT 1031935;					
34					X	X												LD TP: 5N 1E;		R/W OG PIPELINE	AZA-33350	1/24/2008	TO TERM 12/31/2037;

Land Patent Details

Accession Nr: 1138507 Document Type: Serial Patent State: Arizona Issue Date: 3/27/1953 Cancelled: No

Names On Document

STATE OF ARIZONA	
Military Rank:	---

Miscellaneous Information

Land Office:	Phoenix
US Reservations:	Yes
Mineral Reservations:	Yes
Tribe:	---
Militia:	---
State In Favor Of:	---
Authority:	June 28, 1934: Exchange-State Taylor Act (48 Stat. 1269)

Document Numbers

Document Nr:	085274
Misc. Doc. Nr:	---
BLM Serial Nr:	AZPHX 0085274
Indian Allot. Nr:	---

Survey Information

Total Acres:	10303.34
Survey Date:	---
Geographic Name:	---
Metes/Bounds:	No

Land Descriptions

State	Meridian	Twp - Rng	Aliquots	Section	Survey #	County
AZ	Gila-Salt River	009N - 002E	Lot/Trct 1	5		Yavapai
REMARKS: LOT 1 OF NENE QUARTER ALL URANIUM THORIUM OR OTHER MINERALS RESERVED TO US						
AZ	Gila-Salt River	009N - 002E	Lot/Trct 2	5		Yavapai
REMARKS: LOT 2 OF NWNE QUARTER ALL URANIUM THORIUM OR OTHER MINERALS RESERVED TO US						
AZ	Gila-Salt River	009N - 002E	Lot/Trct 3	5		Yavapai
REMARKS: LOT 3 OF NENW QUARTER ALL URANIUM THORIUM OR OTHER MINERALS RESERVED TO US						
AZ	Gila-Salt River	009N - 002E	Lot/Trct 4	5		Yavapai
REMARKS: LOT 4 OF NWNW QUARTER ALL URANIUM THORIUM OR OTHER MINERALS RESERVED TO US						
AZ	Gila-Salt River	009N - 002E	S½N½	5		Yavapai
REMARKS: ALL URANIUM THORIUM OR OTHER MINERALS RESERVED TO US						
AZ	Gila-Salt River	009N - 002E	S½	5		Yavapai
REMARKS: ALL URANIUM THORIUM OR OTHER MINERALS RESERVED TO US						
AZ	Gila-Salt River	009N - 002E		8		Yavapai
REMARKS: ALL URANIUM THORIUM OR OTHER MINERALS RESERVED TO US						
AZ	Gila-Salt River	009N - 002E		17		Yavapai
REMARKS: ALL URANIUM THORIUM OR OTHER MINERALS RESERVED TO US						
AZ	Gila-Salt River	009N - 002E		20		Yavapai
REMARKS: ALL URANIUM THORIUM OR OTHER MINERALS RESERVED TO US						
AZ	Gila-Salt River	009½N - 002E	Lot/Trct 1	19		Yavapai
REMARKS: LOT 1 OF SWNW QUARTER ALL URANIUM THORIUM OR OTHER MINERALS RESERVED TO US						
AZ	Gila-Salt River	009½N - 002E	Lot/Trct 2	19		Yavapai
REMARKS: LOT 2 OF SENW QUARTER ALL URANIUM THORIUM OR OTHER MINERALS RESERVED TO US						
AZ	Gila-Salt River	009½N - 002E	Lot/Trct 3	19		Yavapai
REMARKS: LOT 3 OF SWNE QUARTER ALL URANIUM THORIUM OR OTHER MINERALS RESERVED TO US						
AZ	Gila-Salt River	009½N - 002E	Lot/Trct 4	19		Yavapai
REMARKS: LOT 4 OF SENE QUARTER ALL URANIUM THORIUM OR OTHER MINERALS RESERVED TO US						
AZ	Gila-Salt River	009½N - 002E	Lot/Trct 5	19		Yavapai
REMARKS: LOT 5 OF NWSW QUARTER ALL URANIUM THORIUM OR OTHER MINERALS RESERVED TO US						
AZ	Gila-Salt River	009½N - 002E	Lot/Trct 6	19		Yavapai
REMARKS: LOT 6 OF SWSW QUARTER ALL URANIUM THORIUM OR OTHER MINERALS RESERVED TO US						
AZ	Gila-Salt River	009½N - 002E	E½SW¼	19		Yavapai
REMARKS: ALL URANIUM THORIUM OR OTHER MINERALS RESERVED TO US						
AZ	Gila-Salt River	009½N - 002E	SE¼	19		Yavapai
REMARKS: ALL URANIUM THORIUM OR OTHER MINERALS RESERVED TO US						
AZ	Gila-Salt River	009½N - 002E	Lot/Trct 1	27		Yavapai
REMARKS: LOT 1 OF NENE QUARTER ALL URANIUM THORIUM OR OTHER MINERALS RESERVED TO US						
AZ	Gila-Salt River	009½N - 002E	Lot/Trct 2	27		Yavapai
REMARKS: LOT 2 OF NWNE QUARTER ALL URANIUM THORIUM OR OTHER MINERALS RESERVED TO US						
AZ	Gila-Salt River	009½N - 002E	Lot/Trct 3	27		Yavapai
REMARKS: LOT 3 OF NENW QUARTER ALL URANIUM THORIUM OR OTHER MINERALS RESERVED TO US						
AZ	Gila-Salt River	009½N - 002E	Lot/Trct 4	27		Yavapai
REMARKS: LOT 4 OF NWNW QUARTER ALL URANIUM THORIUM OR OTHER MINERALS RESERVED TO US						
AZ	Gila-Salt River	009½N - 002E	S½N½	27		Yavapai
REMARKS: ALL URANIUM THORIUM OR OTHER MINERALS RESERVED TO US						
AZ	Gila-Salt River	009½N - 002E	Lot/Trct 1	28		Yavapai
REMARKS: LOT 1 OF NENE QUARTER ALL URANIUM THORIUM OR OTHER MINERALS RESERVED TO US						
AZ	Gila-Salt River	009½N - 002E	Lot/Trct 2	28		Yavapai
REMARKS: LOT 2 OF NWNE QUARTER ALL URANIUM THORIUM OR OTHER MINERALS RESERVED TO US						
AZ	Gila-Salt River	009½N - 002E	S½NE¼	28		Yavapai
REMARKS: ALL URANIUM THORIUM OR OTHER MINERALS RESERVED TO US						
AZ	Gila-Salt River	009½N - 002E	W½	29		Yavapai
REMARKS: ALL URANIUM THORIUM OR OTHER MINERALS RESERVED TO US						
AZ	Gila-Salt River	009½N - 002E	Lot/Trct 1	30		Yavapai
REMARKS: LOT 1 OF NWNW QUARTER ALL URANIUM THORIUM OR OTHER MINERALS RESERVED TO US						

AZ	Gila-Salt River	009½N - 002E	Lot/Trct 2	30		Yavapai
REMARKS: LOT 2 OF SWNW QUARTER ALL URANIUM THORIUM OR OTHER MINERALS RESERVED TO US						
AZ	Gila-Salt River	009½N - 002E	Lot/Trct 3	30		Yavapai
REMARKS: LOT 3 OF NWSW QUARTER ALL URANIUM THORIUM OR OTHER MINERALS RESERVED TO US						
AZ	Gila-Salt River	009½N - 002E	Lot/Trct 4	30		Yavapai
REMARKS: LOT 4 OF SWSW QUARTER ALL URANIUM THORIUM OR OTHER MINERALS RESERVED TO US						
AZ	Gila-Salt River	009½N - 002E	E½W½	30		Yavapai
REMARKS: ALL URANIUM THORIUM OR OTHER MINERALS RESERVED TO US						
AZ	Gila-Salt River	009½N - 002E	E½	30		Yavapai
REMARKS: ALL URANIUM THORIUM OR OTHER MINERALS RESERVED TO US						
AZ	Gila-Salt River	009½N - 002E	Lot/Trct 1	31		Yavapai
REMARKS: LOT 1 OF NWNW QUARTER ALL URANIUM THORIUM OR OTHER MINERALS RESERVED TO US						
AZ	Gila-Salt River	009½N - 002E	Lot/Trct 2	31		Yavapai
REMARKS: LOT 2 OF SWNW QUARTER ALL URANIUM THORIUM OR OTHER MINERALS RESERVED TO US						
AZ	Gila-Salt River	009½N - 002E	Lot/Trct 3	31		Yavapai
REMARKS: LOT 3 OF NWSW QUARTER ALL URANIUM THORIUM OR OTHER MINERALS RESERVED TO US						
AZ	Gila-Salt River	009½N - 002E	Lot/Trct 4	31		Yavapai
REMARKS: LOT 4 OF SWSW QUARTER ALL URANIUM THORIUM OR OTHER MINERALS RESERVED TO US						
AZ	Gila-Salt River	009½N - 002E	E½W½	31		Yavapai
REMARKS: ALL URANIUM THORIUM OR OTHER MINERALS RESERVED TO US						
AZ	Gila-Salt River	009½N - 002E	E½	31		Yavapai
REMARKS: ALL URANIUM THORIUM OR OTHER MINERALS RESERVED TO US						
AZ	Gila-Salt River	010N - 002E	Lot/Trct 1	5		Yavapai
REMARKS: LOT 1 OF NENE QUARTER ALL URANIUM THORIUM OR OTHER MINERALS RESERVED TO US						
AZ	Gila-Salt River	010N - 002E	Lot/Trct 2	5		Yavapai
REMARKS: LOT 2 OF NWNE QUARTER ALL URANIUM THORIUM OR OTHER MINERALS RESERVED TO US						
AZ	Gila-Salt River	010N - 002E	Lot/Trct 3	5		Yavapai
REMARKS: LOT 3 OF NENW QUARTER ALL URANIUM THORIUM OR OTHER MINERALS RESERVED TO US						
AZ	Gila-Salt River	010N - 002E	Lot/Trct 4	5		Yavapai
REMARKS: LOT 4 OF NWNW QUARTER ALL URANIUM THORIUM OR OTHER MINERALS RESERVED TO US						
AZ	Gila-Salt River	010N - 002E	S½N½	5		Yavapai
REMARKS: ALL URANIUM THORIUM OR OTHER MINERALS RESERVED TO US						
AZ	Gila-Salt River	010N - 002E	S½	5		Yavapai
REMARKS: ALL URANIUM THORIUM OR OTHER MINERALS RESERVED TO US						
AZ	Gila-Salt River	010N - 002E	Lot/Trct 1	6		Yavapai
REMARKS: LOT 1 OF NENE QUARTER ALL URANIUM THORIUM OR OTHER MINERALS RESERVED TO US						
AZ	Gila-Salt River	010N - 002E	Lot/Trct 2	6		Yavapai
REMARKS: LOT 2 OF NWNE QUARTER ALL URANIUM THORIUM OR OTHER MINERALS RESERVED TO US						
AZ	Gila-Salt River	010N - 002E	Lot/Trct 3	6		Yavapai
REMARKS: LOT 3 OF NENW QUARTER ALL URANIUM THORIUM OR OTHER MINERALS RESERVED TO US						
AZ	Gila-Salt River	010N - 002E	Lot/Trct 4	6		Yavapai
REMARKS: LOT 4 OF NWNW QUARTER ALL URANIUM THORIUM OR OTHER MINERALS RESERVED TO US						
AZ	Gila-Salt River	010N - 002E	Lot/Trct 5	6		Yavapai
REMARKS: LOT 5 OF SWNW QUARTER ALL URANIUM THORIUM OR OTHER MINERALS RESERVED TO US						
AZ	Gila-Salt River	010N - 002E	Lot/Trct 6	6		Yavapai
REMARKS: LOT 6 OF NWSW QUARTER ALL URANIUM THORIUM OR OTHER MINERALS RESERVED TO US						
AZ	Gila-Salt River	010N - 002E	Lot/Trct 7	6		Yavapai
REMARKS: LOT 7 OF NWSW QUARTER ALL URANIUM THORIUM OR OTHER MINERALS RESERVED TO US						
AZ	Gila-Salt River	010N - 002E	Lot/Trct 8	6		Yavapai
REMARKS: LOT 8 OF SWSW QUARTER ALL URANIUM THORIUM OR OTHER MINERALS RESERVED TO US						
AZ	Gila-Salt River	010N - 002E	Lot/Trct 9	6		Yavapai
REMARKS: LOT 9 OF SWSW QUARTER ALL URANIUM THORIUM OR OTHER MINERALS RESERVED TO US						
AZ	Gila-Salt River	010N - 002E	S½NE¼	6		Yavapai
REMARKS: ALL URANIUM THORIUM OR OTHER MINERALS RESERVED TO US						
AZ	Gila-Salt River	010N - 002E	SE¼NW¼	6		Yavapai
REMARKS: ALL URANIUM THORIUM OR OTHER MINERALS RESERVED TO US						
AZ	Gila-Salt River	010N - 002E	E½SW¼	6		Yavapai
REMARKS: ALL URANIUM THORIUM OR OTHER MINERALS RESERVED TO US						
AZ	Gila-Salt River	010N - 002E	SE¼	6		Yavapai
REMARKS: ALL URANIUM THORIUM OR OTHER MINERALS RESERVED TO US						
AZ	Gila-Salt River	010N - 002E	Lot/Trct 1	7		Yavapai
REMARKS: LOT 1 OF NWNW QUARTER ALL URANIUM THORIUM OR OTHER MINERALS RESERVED TO US						
AZ	Gila-Salt River	010N - 002E	Lot/Trct 2	7		Yavapai
REMARKS: LOT 2 OF NWNW QUARTER ALL URANIUM THORIUM OR OTHER MINERALS RESERVED TO US						
AZ	Gila-Salt River	010N - 002E	Lot/Trct 3	7		Yavapai
REMARKS: LOT 3 OF SWNW QUARTER ALL URANIUM THORIUM OR OTHER MINERALS RESERVED TO US						
AZ	Gila-Salt River	010N - 002E	Lot/Trct 4	7		Yavapai
REMARKS: LOT 4 OF SWNW QUARTER ALL URANIUM THORIUM OR OTHER MINERALS RESERVED TO US						
AZ	Gila-Salt River	010N - 002E	Lot/Trct 5	7		Yavapai
REMARKS: LOT 5 OF NWSW QUARTER ALL URANIUM THORIUM OR OTHER MINERALS RESERVED TO US						
AZ	Gila-Salt River	010N - 002E	Lot/Trct 6	7		Yavapai
REMARKS: LOT 6 OF NWSW QUARTER ALL URANIUM THORIUM OR OTHER MINERALS RESERVED TO US						
AZ	Gila-Salt River	010N - 002E	Lot/Trct 7	7		Yavapai
REMARKS: LOT 7 OF SWSW QUARTER ALL URANIUM THORIUM OR OTHER MINERALS RESERVED TO US						
AZ	Gila-Salt River	010N - 002E	Lot/Trct 8	7		Yavapai
REMARKS: LOT 8 OF SWSW QUARTER ALL URANIUM THORIUM OR OTHER MINERALS RESERVED TO US						
AZ	Gila-Salt River	010N - 002E	E½W½	7		Yavapai

Gila-Salt River	010N - 002E	SW¼SW¼	33	Yavapai
-----------------	-------------	--------	----	---------

REMARKS: ALL URANIUM THORIUM OR OTHER MINERALS RESERVED TO US

The United States of America,

To all to whom these presents shall come, Greeting:

WHEREAS, under the provisions of Section 8 of the Act of June 28, 1934 (48 Stat. 1269), entitled "An Act To stop injury to the public grazing lands by preventing overgrazing and soil deterioration, to provide for their orderly use, improvement, and development, to stabilize the livestock industry dependent upon the public range, and for other purposes," as amended by Section 3 of the Act of June 26, 1936 (49 Stat. 1976), the State of Arizona, in exchange for certain other lands situated in said State, has selected the following described tracts of land:

Gila and Salt River Meridian, Arizona.

T. 9 N., R. 2 E.,
 sec. 5, all;
 sec. 8, all;
 sec. 17, all;
 sec. 20, all;

T. 9½ N., R. 2 E.,
 sec. 19, Lots 1, 2, 3, 4, 5, 6, E½SW¼, SE¼;
 sec. 27, Lots 1, 2, 3, 4, S½NW¼;
 sec. 28, Lots 1, 2, S½NE¼;
 sec. 29, W¼;
 sec. 30, all;
 sec. 31, all;

T. 10 N., R. 2 E.,
 sec. 5, all;
 sec. 6, all;
 sec. 7, all;
 sec. 8, all;
 sec. 15, S¼;
 sec. 16, W½SW¼;
 sec. 18, Lots 1, 2, 3, 4, 5, 6, 7, 8, E½W¼;
 sec. 19, Lots 5, 6, 7, 8, E½SW¼;
 sec. 21, all;
 sec. 25, W½W¼;
 sec. 30, Lots 1, 2, 3, 4, 6, 7, 8, 9, 10, E½NW¼;
 sec. 31, Lots 3, 4, 5, 7, 8, 9, 10, E½SW¼;
 sec. 33, SW¼SW¼.

The area described contains 10,235.25 acres, according to the Official Plat of the Survey of the said Land, on file in the Bureau of Land Management:

NOW KNOW YE, That the UNITED STATES OF AMERICA, in consideration of the premises, and in conformity with the said Acts of Congress, HAS GIVEN AND GRANTED, and by these presents DOES GIVE AND GRANT, unto the said State of Arizona, in fee simple, the tracts of land above described; TO HAVE AND TO HOLD the same, together with all the rights, privileges, immunities, and appurtenances, of whatsoever nature, thereunto belonging, unto the said State of Arizona and to its assigns forever; subject to any vested and accrued water rights for mining, agricultural, manufacturing, or other purposes, and rights to ditches and reservoirs used in connection with such water rights, as may be recognized and acknowledged by the local customs, laws, and decisions of courts; and there is reserved from the lands hereby granted a right of way thereon for ditches or canals constructed by the authority of the United States. Reserving, also, to the United States, all minerals in the lands so granted, together with the right to prospect for, mine, and remove the same, as authorized by the provisions of said section 8, as amended as aforesaid. Excepting and reserving, also, to the United States, pursuant to the provisions of the Act of August 1, 1946 (60 Stat. 755), all uranium, thorium or any other material which is or may be determined to be peculiarly essential to the production of fissionable materials, whether or not of commercial value, together with the right of the United States through its authorized agents or representatives at any time to enter upon the land and prospect for, mine, and remove the same.

The $E\frac{1}{2}SW\frac{1}{4}$, $SW\frac{1}{4}SE\frac{1}{4}$ sec. 5, $NE\frac{1}{4}NW\frac{1}{4}$, $W\frac{1}{2}E\frac{1}{2}$ sec. 8, $W\frac{1}{2}SW\frac{1}{4}$ sec. 28, T. 10 N., R. 2 E., are subject to such rights for telephone and telegraph line purposes as the American Telephone and Telegraph Company of Denver, Colorado, may have under the Act of March 4, 1911 (36 Stat. 1253). Reserving unto the United States, its permittee or licensee, the right to enter upon, occupy and use, any part or all of that portion of the Lots 3, 8, 9, $SE\frac{1}{4}NW\frac{1}{4}$, $E\frac{1}{2}SW\frac{1}{4}$ sec. 6, Lots 1, 2, 3, 4, 6, $NE\frac{1}{4}NW\frac{1}{4}$, $NE\frac{1}{4}$ sec. 7, $S\frac{1}{2}NW\frac{1}{4}$, $NE\frac{1}{4}SW\frac{1}{4}$, $N\frac{1}{2}SE\frac{1}{4}$, $SE\frac{1}{4}SE\frac{1}{4}$ sec. 8, $SW\frac{1}{4}SW\frac{1}{4}$ sec. 15, T. 10 N., R. 2 E., lying within a strip of land 25 feet wide covered by the transmission line right of way of the Arizona Power Corporation; and that portion of the $SW\frac{1}{4}SW\frac{1}{4}$ said sec. 33, included in electric power transmission line right of way of the Arizona Power Company, for the purposes provided in the Act of June 10, 1920 (41 Stat. 1063), and subject to the conditions and limitations of Section 24 of said Act, as amended by the Act of August 26, 1935 (49 Stat. 846). There is reserved to the United States the Range Improvement Projects, No. 2006032 in the $NW\frac{1}{4}NW\frac{1}{4}$ sec. 5, T. 9 N., R. 2 E., and No. 2006031 in the $SW\frac{1}{4}SW\frac{1}{4}$ sec. 21, T. 10 N., R. 2 E.; together with the right of ingress and egress to the lands as necessary for the proper maintenance of said projects as long as they exist in their present locations.

IN TESTIMONY WHEREOF, the undersigned authorized officer of the Bureau of Land Management, in accordance with the provisions of the Act of June 17, 1948 (62 Stat., 476), has, in the name of the United States, caused these letters
[SEAL]
to be made Patent, and the Seal of the Bureau to be hereunto affixed.

GIVEN under my hand, in the District of Columbia, the **TWENTY-SEVENTH**
day of **MARCH** in the year of our Lord one thousand nine
hundred and **FIFTY-THREE** and of the Independence of the
United States the one hundred and **SEVENTY-SEVENTH**.

For the Director, Bureau of Land Management.

By *Rose M. Beall*
Chief, Patents Section.

Patent No. 118507

DEPARTMENT OF INTERIOR
BUREAU OF LAND MANAGEMENT

Input Parameters for Geographic Report with Land

System Id = CR

Admin State = AZ

Geo State = AZ

Casetype Begins With

Case Disp Txt = AUTHORIZED, CANCELLED, EXPIRED, PENDING, REJECTED, RELINQUISHED, WITHDRAWN

Mer Twp Rng =

Section =

Mtrs = 14 0100N 0020E 007, 14 0100N 0020E 999, 14 0110N 0010E 036, 14 0110N 0010E 999

Commodity =

Commodity Txt =

Pending Org =

Pend Org Decode =

Total Rows Returned: 8

RUN TIME: 04:12 PM

UNITED STATES DEPARTMENT OF INTERIOR
BUREAU OF LAND MANAGEMENT
GEOGRAPHIC REPORT WITH LAND
Sorted by Meridian Township Range

RUN DATE: 03/19/2014
Page 1 of 2

Adm State: AZ

Serial Number: AZA 019323

Total Case Acres: 82.000

<u>Casetype</u>	<u>Case Disp</u>	14	0100N	0020E	<u>Sect</u>	<u>Sur Typ</u>	<u>Sur Num</u>	<u>Suff</u>	<u>Subdivision</u>	<u>Act Pend</u>
282201	AUTHORIZED				007	FF		1	N2,SE;	

Serial Number: AZA 022699PT

Total Case Acres: 12,382.940

<u>Casetype</u>	<u>Case Disp</u>	14	0100N	0020E	<u>Sect</u>	<u>Sur Typ</u>	<u>Sur Num</u>	<u>Suff</u>	<u>Subdivision</u>	<u>Act Pend</u>
221006	AUTHORIZED				007	ALIQUOTS			E2,E2W2; 1-8;	

Serial Number: AZA 031558

Total Case Acres: 1.000

<u>Casetype</u>	<u>Case Disp</u>	14	0100N	0020E	<u>Sect</u>	<u>Sur Typ</u>	<u>Sur Num</u>	<u>Suff</u>	<u>Subdivision</u>	<u>Act Pend</u>
293200	AUTHORIZED				007	FF			PORTIONS OF;	

Serial Number: AZA 031851

Total Case Acres: 1.000

<u>Casetype</u>	<u>Case Disp</u>	14	0100N	0020E	<u>Sect</u>	<u>Sur Typ</u>	<u>Sur Num</u>	<u>Suff</u>	<u>Subdivision</u>	<u>Act Pend</u>
293200	AUTHORIZED				007	FF			PORTION OF;	

Serial Number: AZA 032607

Total Case Acres: 1.000

<u>Casetype</u>	<u>Case Disp</u>	14	0100N	0020E	<u>Sect</u>	<u>Sur Typ</u>	<u>Sur Num</u>	<u>Suff</u>	<u>Subdivision</u>	<u>Act Pend</u>
293200	AUTHORIZED				007	FF			PORTION OF;	

RUN TIME: 04:12 PM

Adm State: AZ

UNITED STATES DEPARTMENT OF INTERIOR
BUREAU OF LAND MANAGEMENT
GEOGRAPHIC REPORT WITH LAND
Sorted by Meridian Township Range

RUN DATE: 03/19/2014
Page 2 of 2

Serial Number: AZA 033074

Total Case Acres: 0.230

<u>Casetype</u>	<u>Case Disp</u>	14	0100N	0020E	<u>Sect</u>	<u>Sur Typ</u>	<u>Sur Num</u>	<u>Suff</u>	<u>Subdivision</u>	<u>Act Pend</u>
292006	AUTHORIZED				007	ALIQ			NWNE;	

Serial Number: AZA 033821

Total Case Acres: 1.000

<u>Casetype</u>	<u>Case Disp</u>	14	0100N	0020E	<u>Sect</u>	<u>Sur Typ</u>	<u>Sur Num</u>	<u>Suff</u>	<u>Subdivision</u>	<u>Act Pend</u>
293200	AUTHORIZED				007	FF			PORTION OF;	

